

WINDSOR WINDOWS & DOORS

PINNACLE CLAD IMPACT OUTSWING DOOR (HVHZ)

INSTALLATION NOTES:

- ONE (1) INSTALLATION ANCHOR IS REQUIRED AT EACH ANCHOR LOCATION SHOWN UNLESS OTHERWISE NOTED.
- THE NUMBER OF INSTALLATION ANCHORS DEPICTED IS THE MINIMUM NUMBER OF ANCHORS TO BE USED FOR PRODUCT INSTALLATION OF THE MAXIMUM SIZE LISTED.
- INSTALL INDIVIDUAL INSTALLATION ANCHORS WITHIN A TOLERANCE OF ±1/2 INCH (I.E., WITHOUT CONSIDERATION OF TOLERANCES). TOLERANCES ARE NOT CUMULATIVE FROM ONE INSTALLATION ANCHOR TO THE NEXT.
- SHIM AS REQUIRED AT EACH INSTALLATION ANCHOR WITH LOAD BEARING SHIM(S). MAXIMUM ALLOWABLE SHIM STACK TO BE 1/4 INCH. SHIM WHERE SPACE OF 1/16 INCH OR GREATER OCCURS. SHIM(S) SHALL BE CONSTRUCTED OF HIGH DENSITY PLASTIC OR BETTER.
- REFER TO SHEETS 4 - 7 FOR INSTALLATION DETAILS, ANCHOR SELECTION, AND ANCHOR REQUIREMENTS.
- SEALANT SHALL BE USED BETWEEN NAIL FIN AND SUBSTRATE.
- MINIMUM EMBEDMENT AND EDGE DISTANCE EXCLUDE WALL FINISHES, INCLUDING BUT NOT LIMITED TO STUCCO, FOAM, BRICK VENEER, AND SIDING.
- INSTALLATION ANCHORS AND ASSOCIATED HARDWARE MUST BE MADE OF CORROSION RESISTANT MATERIAL OR HAVE A CORROSION RESISTANT COATING.
- FOR HOLLOW BLOCK AND GROUT FILLED BLOCK, DO NOT INSTALL INSTALLATION ANCHORS INTO MORTAR JOINTS. EDGE DISTANCE IS MEASURED FROM FREE EDGE OF BLOCK OR EDGE OF MORTAR JOINT INTO FACE SHELL OF BLOCK.
- INSTALLATION ANCHORS SHALL BE INSTALLED IN ACCORDANCE WITH ANCHOR MANUFACTURER'S INSTALLATION INSTRUCTIONS, AND ANCHORS SHALL NOT BE USED IN SUBSTRATES WITH STRENGTHS LESS THAN THE MINIMUM STRENGTH SPECIFIED BY THE ANCHOR MANUFACTURER.
- INSTALLATION ANCHOR CAPACITIES FOR PRODUCTS HEREIN ARE BASED ON SUBSTRATE MATERIALS WITH THE FOLLOWING PROPERTIES:
 - WOOD - MINIMUM SPECIFIC GRAVITY OF 0.55.
 - CONCRETE - MINIMUM COMPRESSIVE STRENGTH OF 3000 PSI.
 - GROUT FILLED CMU - STRENGTH CONFORMANCE TO ASTM C90.
 - STEEL - MINIMUM YIELD STRENGTH OF 33 KSI. MINIMUM 18 GA. WALL THICKNESS

GENERAL NOTES:

- THE PRODUCT SHOWN HEREIN IS DESIGNED AND MANUFACTURED TO COMPLY WITH THE CURRENT FLORIDA BUILDING CODE (FBC), INCLUDING HVHZ AND HAS BEEN EVALUATED ACCORDING TO THE FOLLOWING:
 - ASTM E 1886-13
 - ASTM E 1996-14
 - TAS 201-94
 - TAS 202-94
 - TAS 203-94
 - AAMA/WDMA/CSA 101/I.S.2/A440-17
- ADEQUACY OF THE EXISTING STRUCTURAL CONCRETE/MASONRY AND 2X FRAMING AS A MAIN WIND FORCE RESISTING SYSTEM CAPABLE OF WITHSTANDING AND TRANSFERRING APPLIED PRODUCT LOADS TO THE FOUNDATION IS THE RESPONSIBILITY OF THE ENGINEER OR ARCHITECT OF RECORD FOR THE PROJECT OF INSTALLATION.
- 1X AND 2X BUCKS (WHEN USED) SHALL BE DESIGNED AND ANCHORED TO PROPERLY TRANSFER ALL LOADS TO THE STRUCTURE. BUCK DESIGN AND INSTALLATION IS THE RESPONSIBILITY OF THE ENGINEER OR ARCHITECT OF RECORD FOR THE PROJECT OF INSTALLATION.
- THE INSTALLATION DETAILS DESCRIBED HEREIN ARE GENERIC AND MAY NOT REFLECT ACTUAL CONDITIONS FOR A SPECIFIC SITE. IF SITE CONDITIONS CAUSE INSTALLATION TO DEVIATE FROM THE REQUIREMENTS DETAILED HEREIN, A LICENSED ENGINEER OR ARCHITECT SHALL PREPARE SITE SPECIFIC DOCUMENTS FOR USE WITH THIS DOCUMENT IN NON-HVHZ AREAS.
- APPROVED IMPACT PROTECTIVE SYSTEM **IS NOT REQUIRED** ON THIS PRODUCT IN AREAS REQUIRING IMPACT RESISTANCE.
- DOOR FRAME MATERIAL:
 - WOOD
 - ALUMINUM 6063-T5
- DISSIMILAR METALS INCLUDING FASTENERS THAT MAY COME INTO CONTACT WITH ALUMINUM COMPONENTS SHALL BE PROTECTED IN ACCORDANCE WITH THE FBC.
- DESIGNATIONS "X" AND "O" STAND FOR THE FOLLOWING:
X: OPERABLE PANEL
O: STATIONARY PANEL

TABLE OF CONTENTS		
SHEET	REVISION	SHEET DESCRIPTION
1	-	INSTALLATION & GENERAL NOTES
2	-	ELEVATIONS & ANCHOR LAYOUTS
3	-	VERTICAL SECTIONS
4	-	VERTICAL SECTIONS
5	-	HORIZONTAL SECTIONS
6	-	ANCHOR SCHEDULE
7	-	GLAZING DETAILS AND HARDWARE NOTES

DESIGN PRESSURE TABLE					
TYP. OVERALL SIZE		DESIGN PRESSURE	CONFIGURATION	INSTALLATION METHOD	MISSILE IMPACT RATING
WIDTH	HEIGHT				
75.06"	98.5"	+50/-65 PSF	BI-HINGE XX	THROUGH FRAME, NAIL FIN & CLIP	LMI & SMI
75.06"	98.5"	+50/-65 PSF	STA - ACT OX		



WINDSOR WINDOWS
& DOORS

900 S. 19TH STREET.
WEST DES MOINES, IA 50265
PH: (515)223-6660 FAX: (515)224-1938

PINNACLE CLAD IMPACT
OUTSWING DOOR (HVHZ)

INSTALLATION & GENERAL NOTES

TITLE:

PREPARED BY:

BUILDING DROPS, INC.

398 E. DANIA BEACH BLVD., STE. 338

DANIA BEACH, FL 33004

PH: (954)399-8478

FAX: (954)744-4738

WEB: www.buildingdrops.com



REMARKS

BY

DATE

THE INSTALLATION DETAILS DESCRIBED HEREIN ARE GENERIC AND MAY NOT REFLECT ACTUAL CONDITIONS FOR A SPECIFIC SITE. IF SITE CONDITIONS CAUSE INSTALLATION TO DEVIATE FROM THE REQUIREMENTS DETAILED HEREIN, A LICENSED ENGINEER OR ARCHITECT SHALL PREPARE SITE SPECIFIC DOCUMENTS FOR USE WITH THIS DOCUMENT



FL #:

FL11517

DATE: 07.03.19

DWG. BY:
RV

CHK. BY:
HFN

SCALE: NTS

DWG. #: WWD038

SHEET:

1

OF 7

10/28/2019 6:47 PM

s:\projects\windsor windows and doors\18-0516 - pinnacle outswing door\dwg\wwd038.dwg

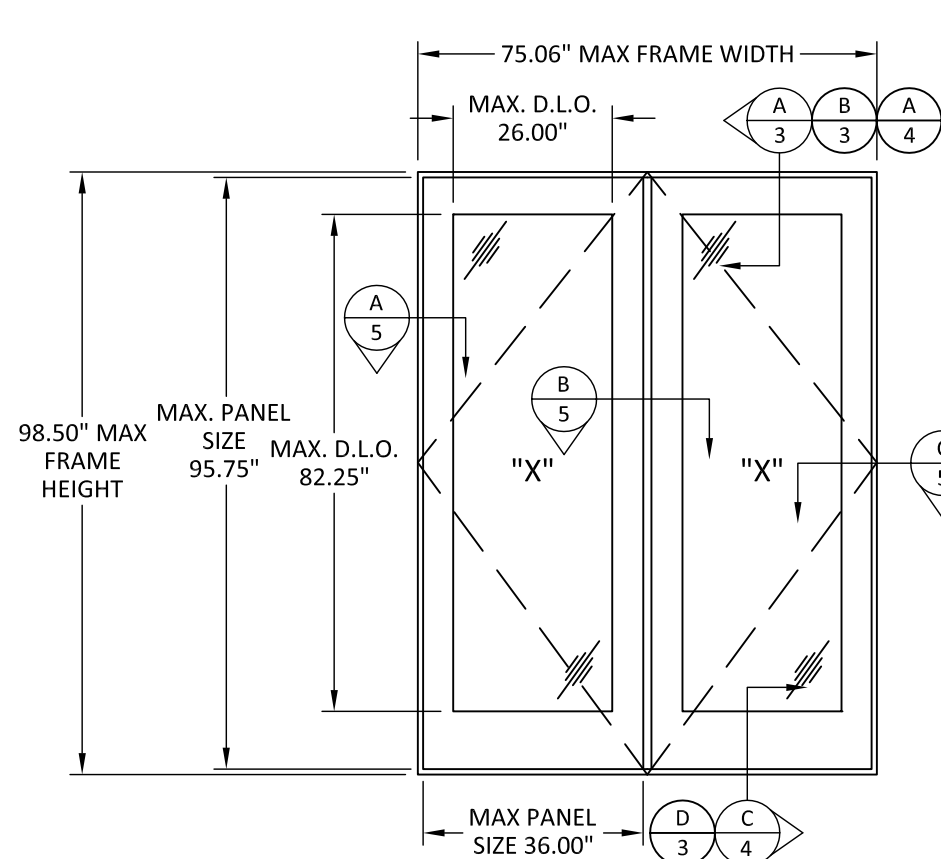

**ELEVATION
BI-HINGE**

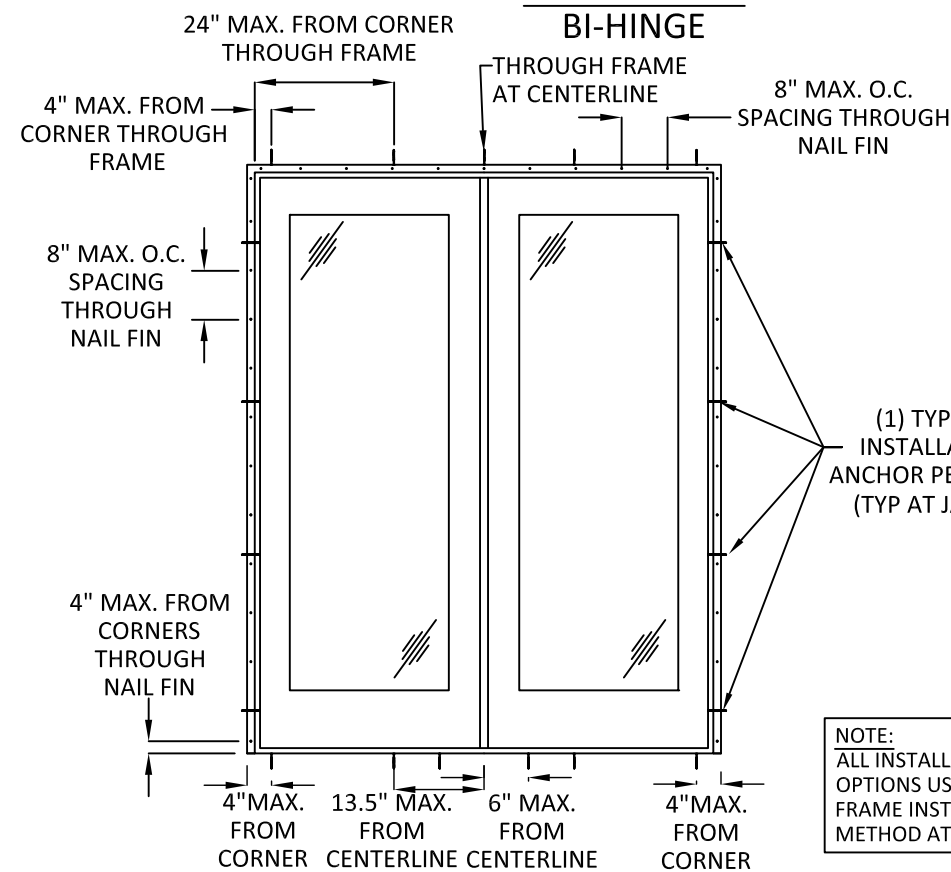

**TYPICAL ANCHOR LAYOUT
NAIL FIN**

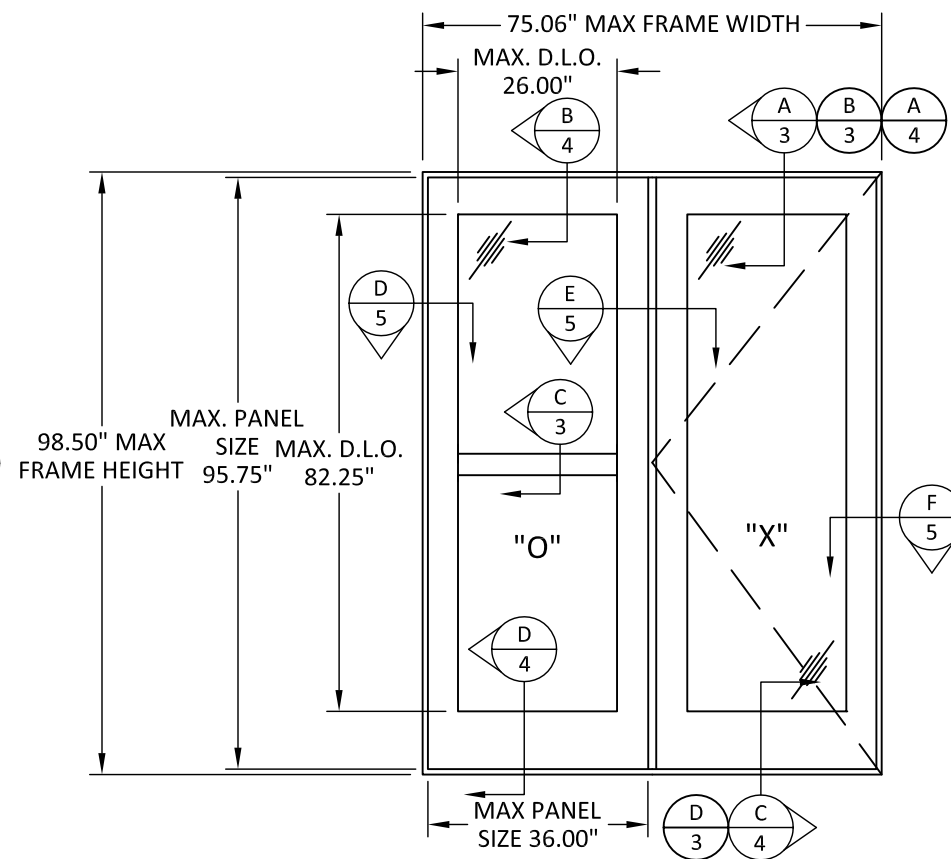

**ELEVATION
STA-ACT**

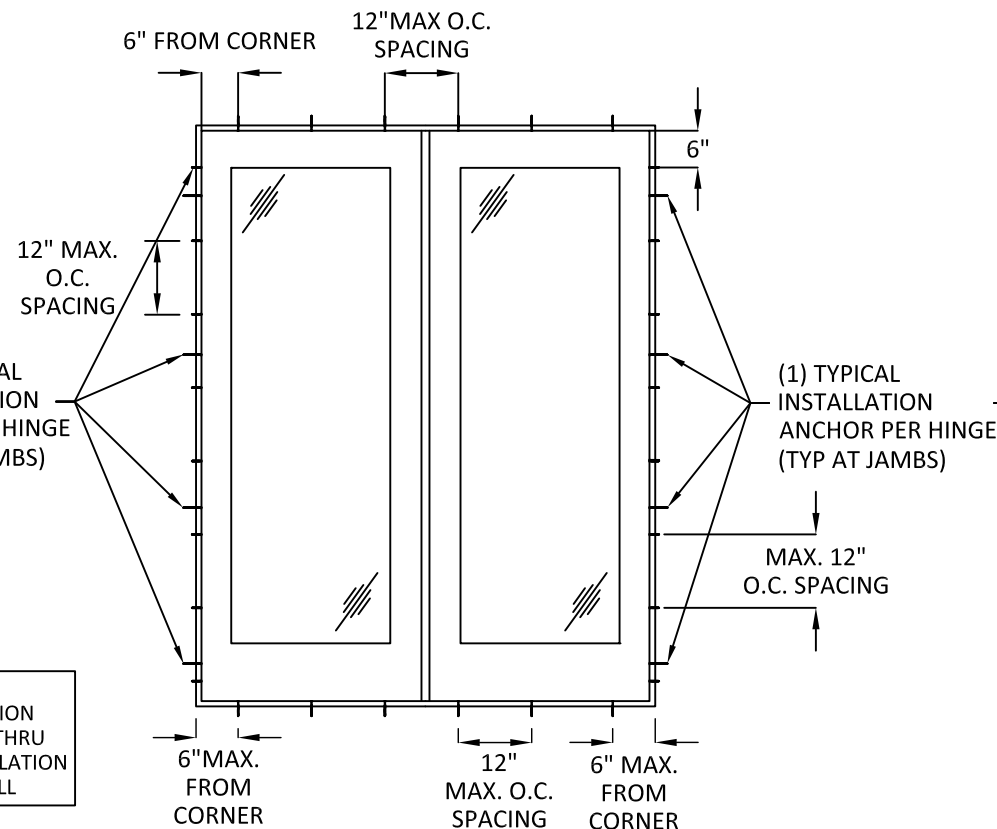

**TYPICAL ANCHOR LAYOUT
THRU FRAME**

QUALIFIED CONFIGURATIONS

FULL LITE

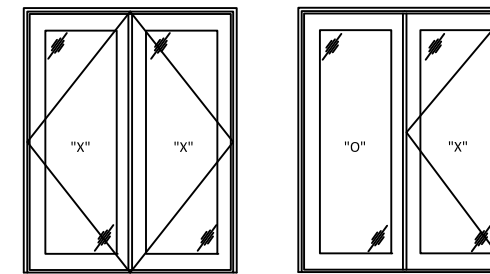

1/2 LITE

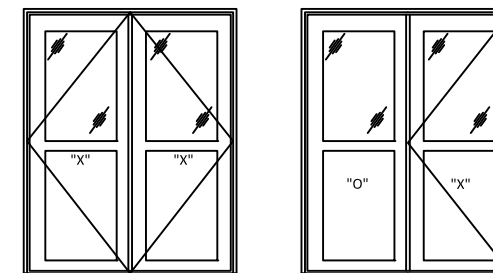

WINDSOR WINDOWS & DOORS

900 S. 19TH STREET.
WEST DES MOINES, IA 50265
PH: (515)223-6660 FAX: (515)224-1938

TITLE: PINNACLE CLAD IMPACT
OUTSWING DOOR (HVHZ)
ELEVATIONS & ANCHOR LAYOUTS

PREPARED BY: BUILDING DROPS, INC.
398 E. DANIA BEACH BLVD., STE. 338
DANIA BEACH, FL 33004
PH: (954)399-8478
FAX: (954)744-4738
WEB: www.buildingdrops.com



REMARKS	BY	DATE

THE INSTALLATION DETAILS DESCRIBED HEREIN ARE GENERIC AND MAY NOT REFLECT ACTUAL CONDITIONS FOR A SPECIFIC SITE. IF SITE CONDITIONS CAUSE INSTALLATION TO DEVIATE FROM THE REQUIREMENTS DETAILED HEREIN, A LICENSED ENGINEER OR ARCHITECT SHALL PREPARE SITE SPECIFIC DOCUMENTS FOR USE WITH THIS DOCUMENT

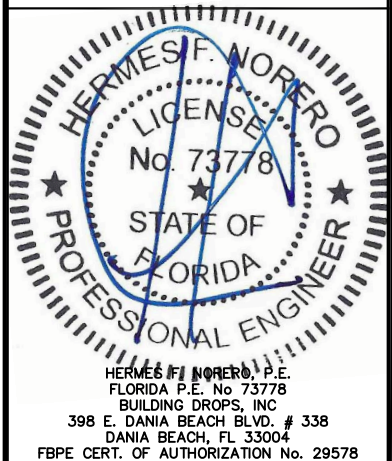

FL #:

FL11517

DATE: **07.03.19**

DWG. BY: **RV** CHK. BY: **HFN**

SCALE: **NTS**

DWG. #: **WWD038**

SHEET:

2

OF 7

TITLE:
PINNACLE CLAD IMPACT
OUTSWING DOOR (HVHZ)

INSTALLATION DETAILS

PREPARED BY:
BUILDING DROPS, INC.

398 E. DANIA BEACH BLVD., STE. 338
DANIA BEACH, FL 33004
PH: (954)399-8478
FAX: (954)744-4738
WEB: www.buildingdrops.com



REMARKS	BY	DATE

THE INSTALLATION DETAILS DESCRIBED HEREIN ARE GENERIC AND MAY NOT REFLECT ACTUAL CONDITIONS FOR A SPECIFIC SITE. IF SITE CONDITIONS CAUSE INSTALLATION TO DEVIATE FROM THE REQUIREMENTS DETAILED HEREIN, A LICENSED ENGINEER OR ARCHITECT SHALL PREPARE SITE SPECIFIC DOCUMENTS FOR USE WITH THIS DOCUMENT



FL #:
FL11517

DATE: **07.03.19**

DWG. BY: **RV** CHK. BY: **HFN**

SCALE: **NTS**

DWG. #: **WWD038**

SHEET:
3

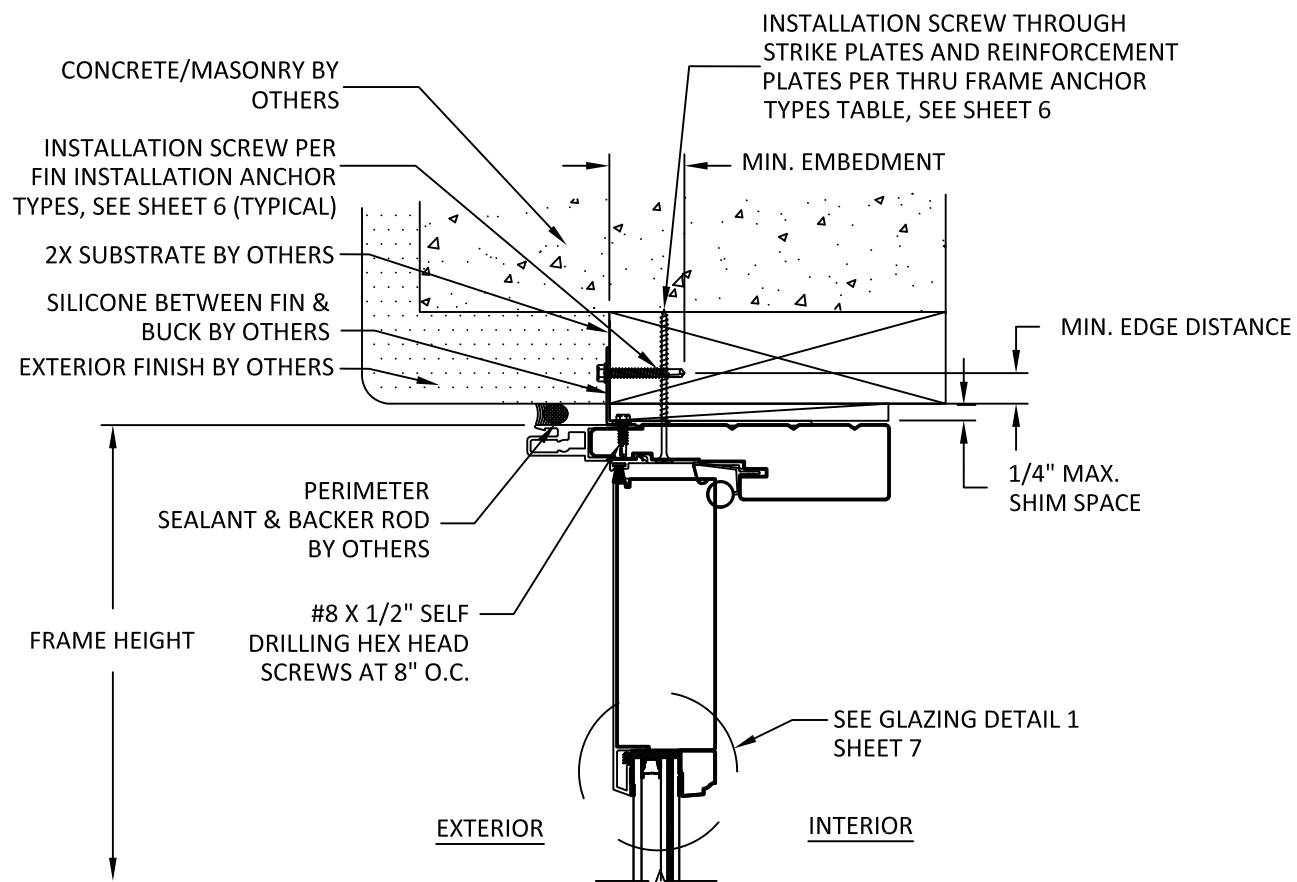

A
3 VERTICAL SECTION
HEAD - FIN FRAME INSTALLATION
(JAMBS ARE INSTALLED THE SAME)

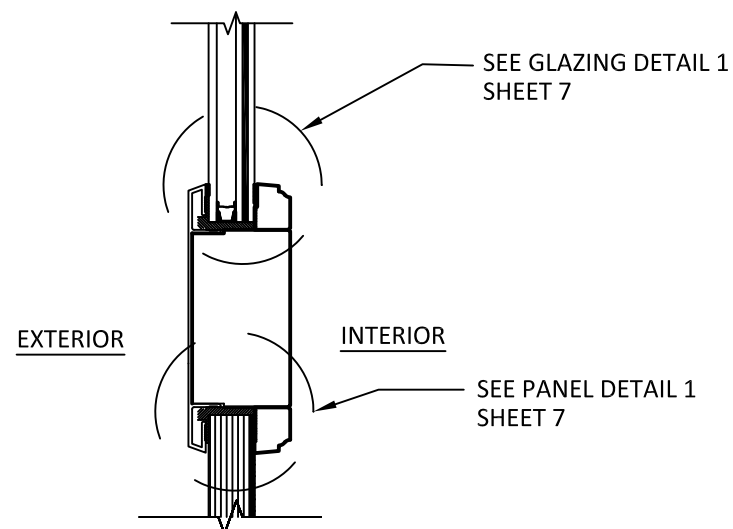

C
3 VERTICAL SECTION
MIDRAIL DETAIL

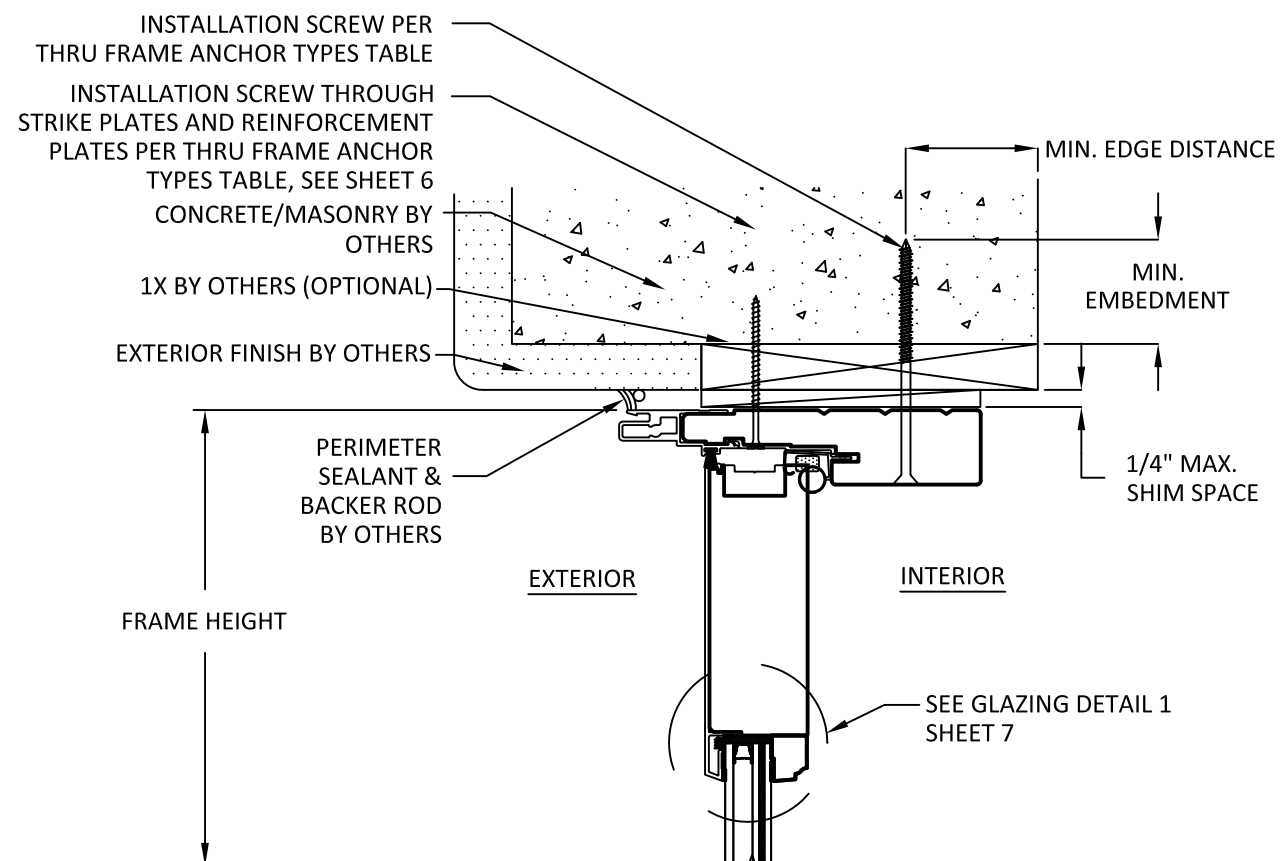

B
3 VERTICAL SECTION
HEAD - THRU FRAME INSTALLATION
(JAMBS ARE INSTALLED THE SAME)

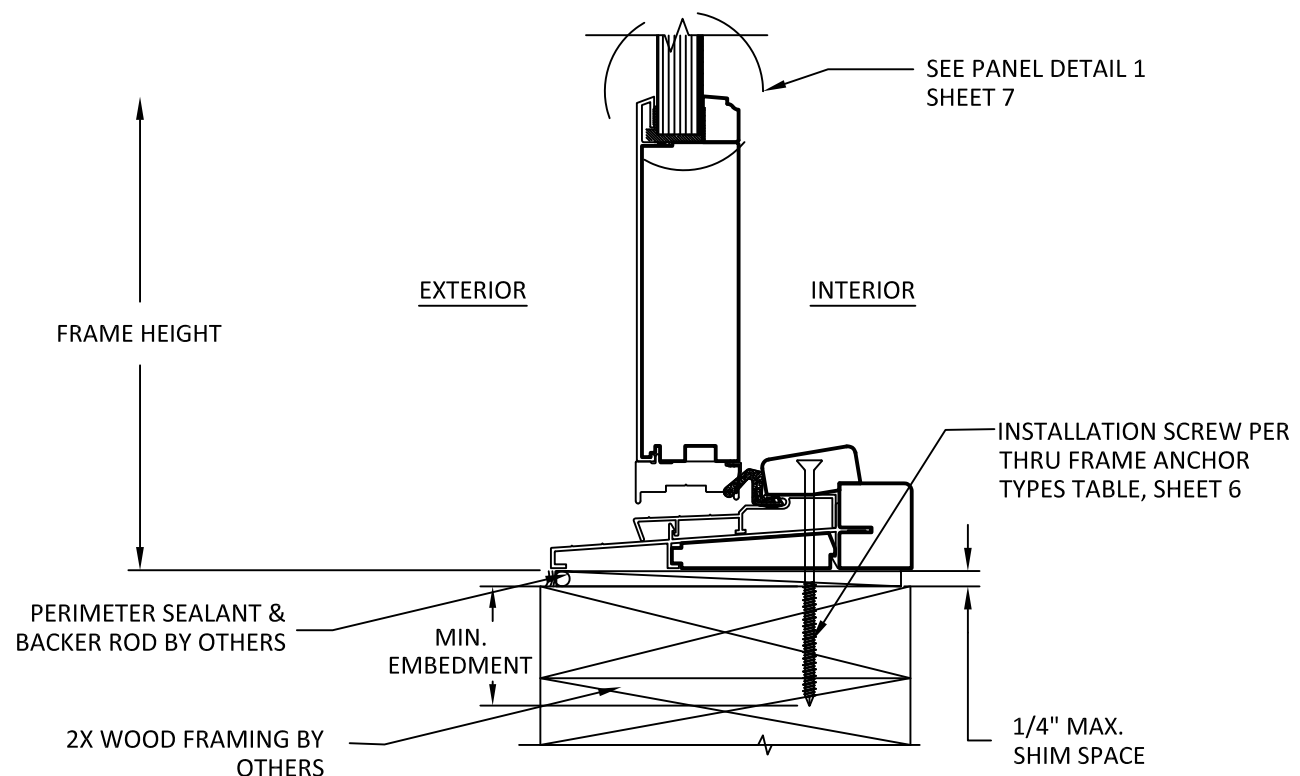

D
3 VERTICAL SECTION
SILL - THRU FRAME INSTALLATION
(HEAD IS INSTALLED THE SAME)

10/28/2019 6:47 PM

s:\projects\windsor windows and doors\fb-18-0516 - pinnacle outswing door\dwgs\wwd038.dwg

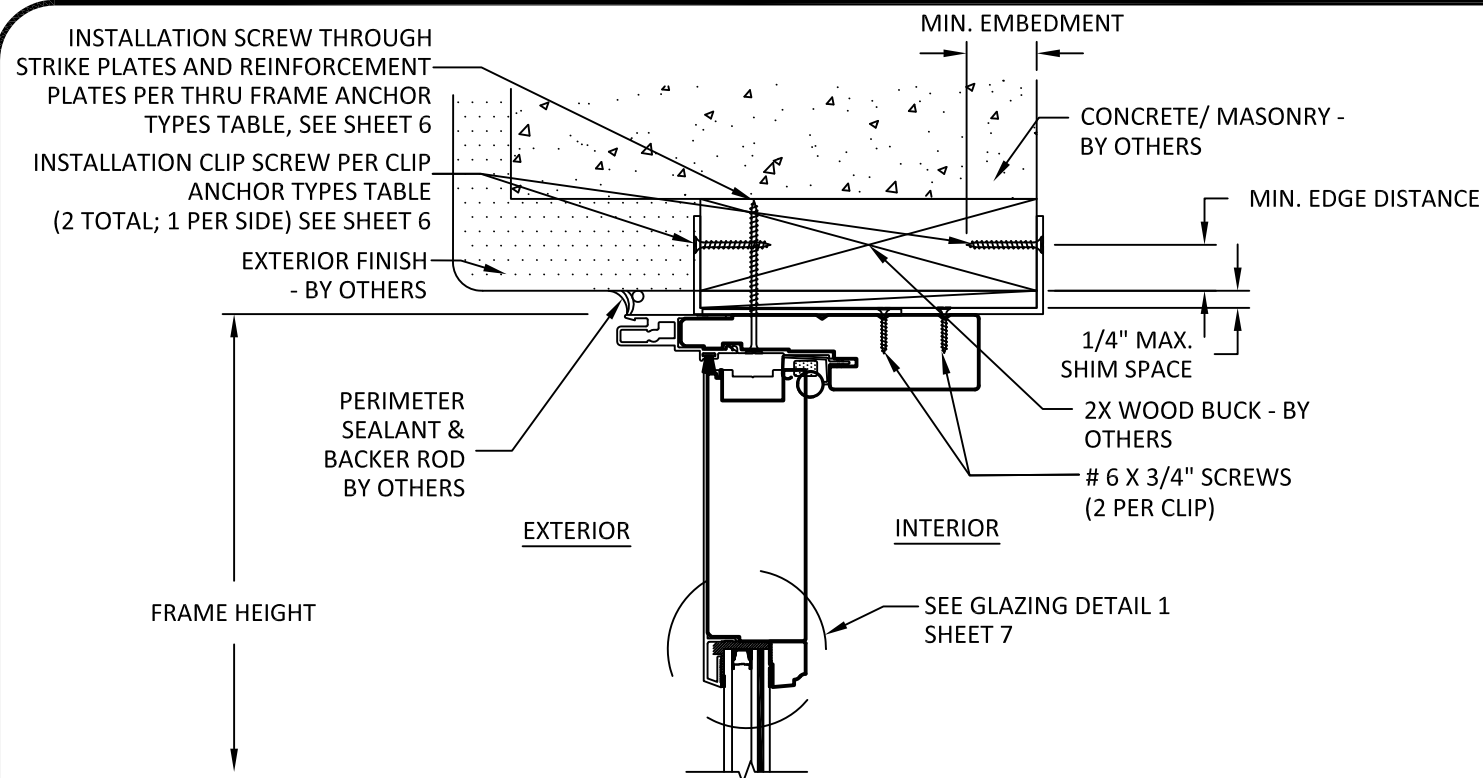

A
4 **VERTICAL SECTION**
HEAD - CLIP INSTALLATION OPTION 1
(JAMBS ARE INSTALLED THE SAME)

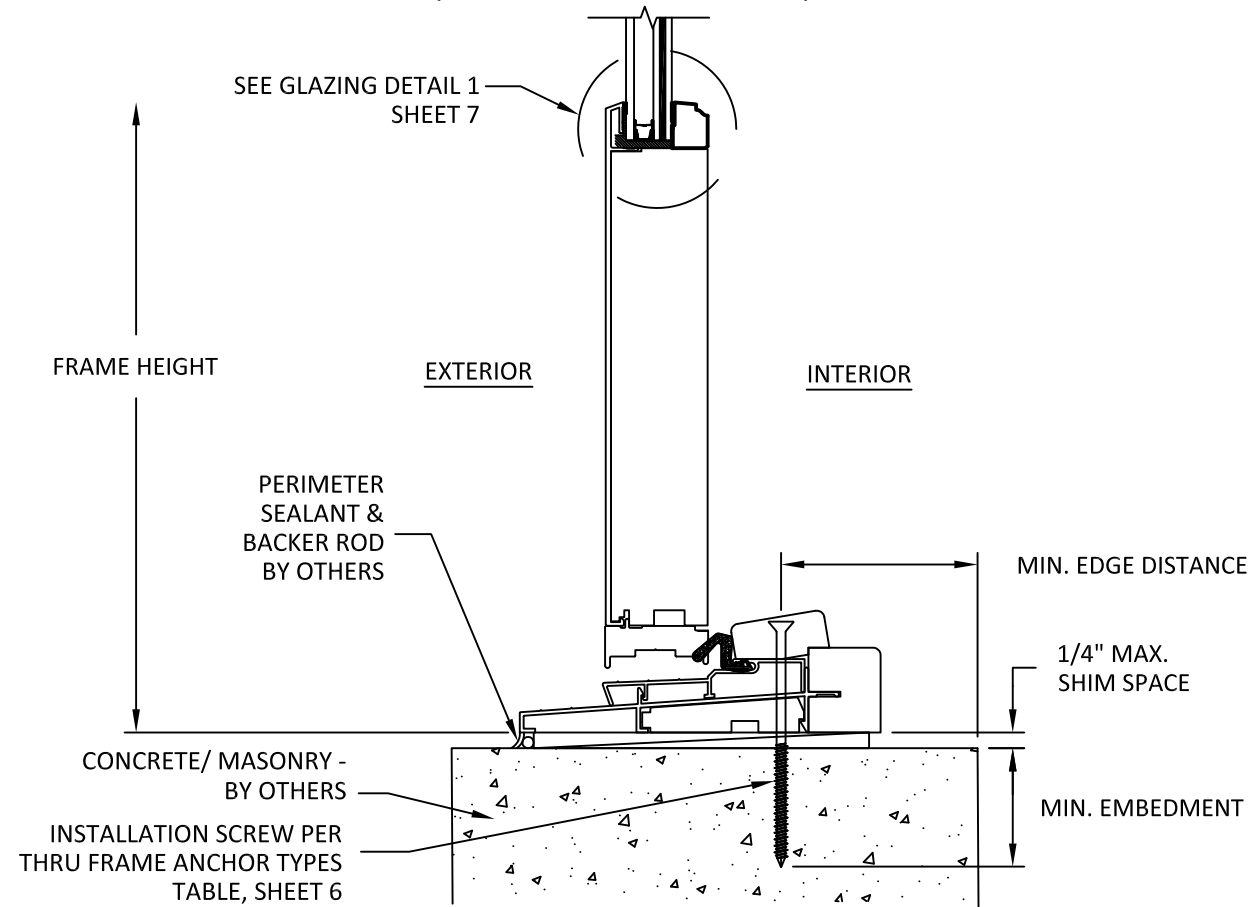

C
4 **VERTICAL SECTION**
SILL - THRU FRAME INSTALLATION

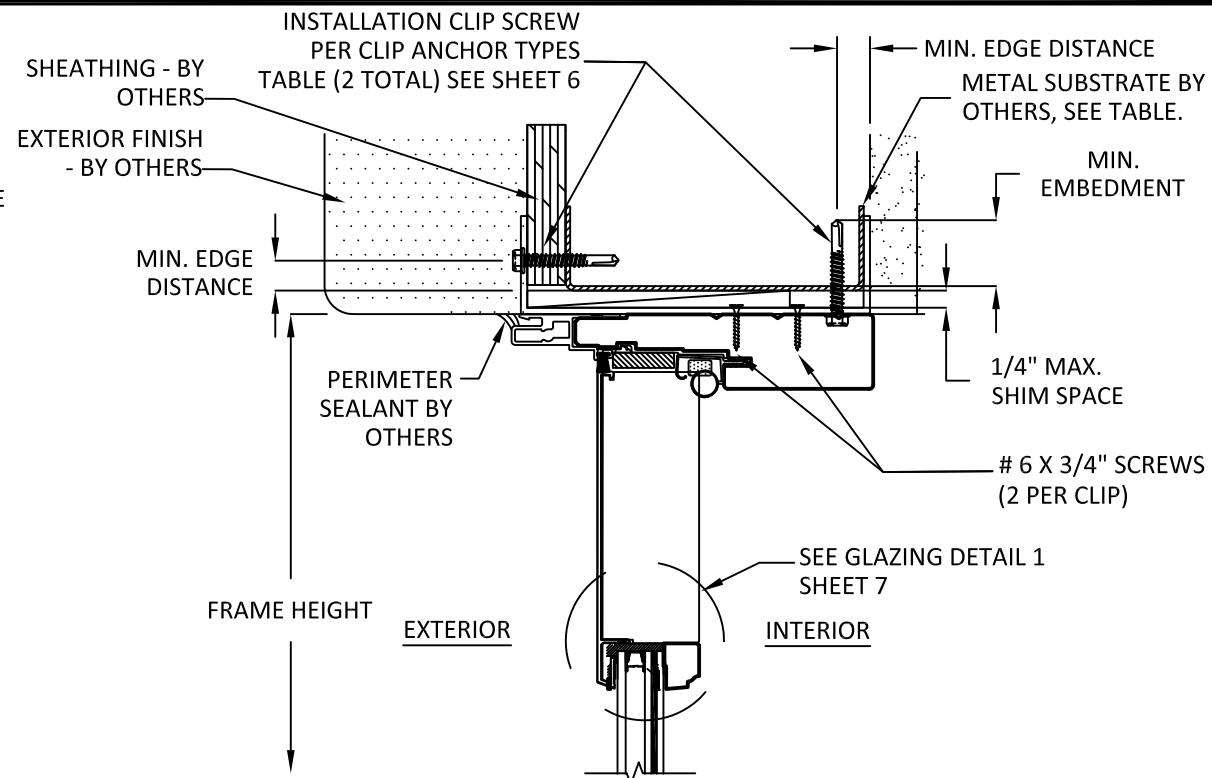

B
4 **VERTICAL SECTION**
HEAD - CLIP INSTALLATION OPTION 2
(JAMBS ARE INSTALLED THE SAME)

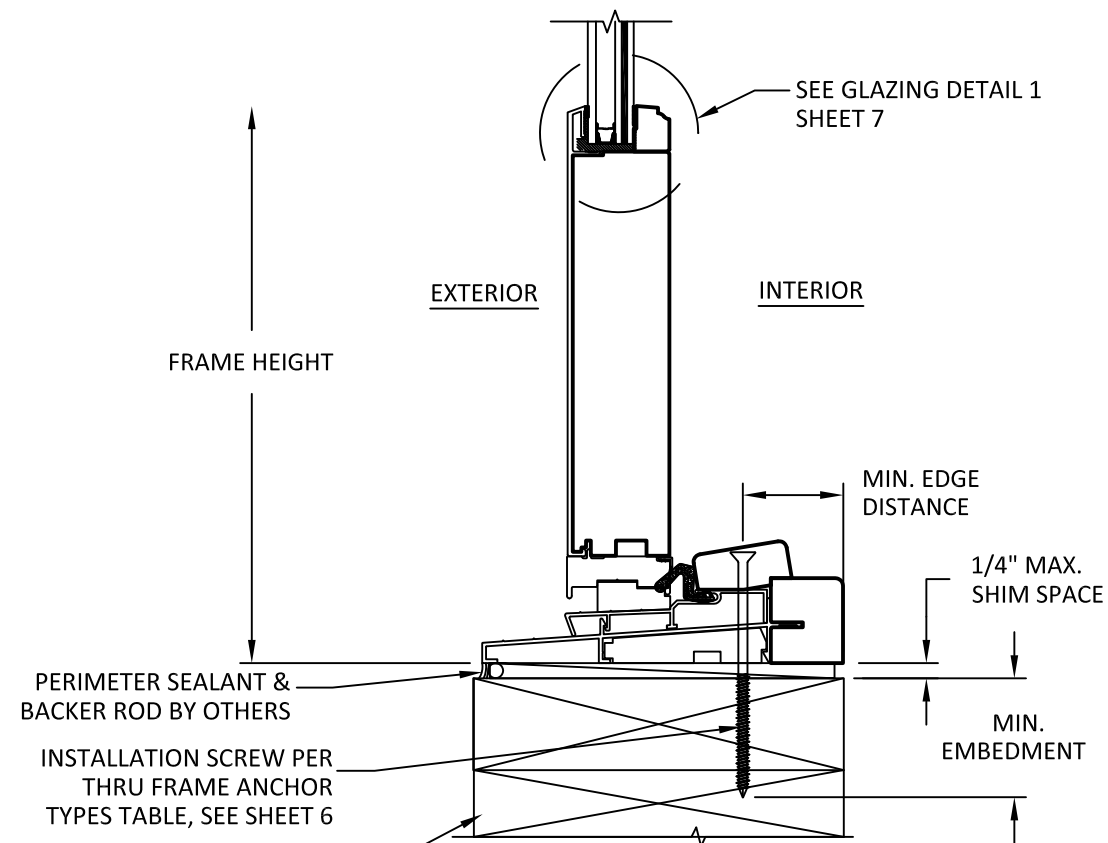

D
4 **VERTICAL SECTION**
SILL - THRU FRAME INSTALLATION



WINDSOR WINDOWS & DOORS

900 S. 19TH STREET.
WEST DES MOINES, IA 50265
PH: (515)223-6660 FAX: (515)224-1938

TITLE:
PINNACLE CLAD IMPACT
OUTSWING DOOR (HVHZ)

INSTALLATION DETAILS

PREPARED BY:
BUILDING DROPS, INC.

398 E. DANIA BEACH BLVD., STE. 338
DANIA BEACH, FL 33004
PH: (954)399-8478
FAX: (954)744-4738
WEB: www.buildingdrops.com

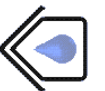

REMARKS	BY	DATE

THE INSTALLATION DETAILS DESCRIBED HEREIN ARE GENERIC AND MAY NOT REFLECT ACTUAL CONDITIONS FOR A SPECIFIC SITE. IF SITE CONDITIONS CAUSE INSTALLATION TO DEVIATE FROM THE REQUIREMENTS DETAILED HEREIN, A LICENSED ENGINEER OR ARCHITECT SHALL PREPARE SITE SPECIFIC DOCUMENTS FOR USE WITH THIS DOCUMENT

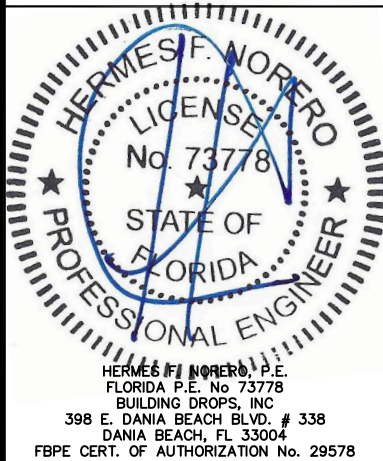

FL #:	FL11517
DATE:	07.03.19
DWG. BY:	RV
CHK. BY:	HFN
SCALE:	NTS
DWG. #:	WWD038
SHEET:	4

PINNACLE CLAD IMPACT
OUTSWING DOOR (HVHZ)

INSTALLATION DETAILS

PREPARED BY:
BUILDING DROPS, INC.

398 E. DANIA BEACH BLVD., STE. 338
DANIA BEACH, FL 33004
PH: (954)399-8478
FAX: (954)744-4738
WEB: www.buildingdrops.com



TITLE:

REMARKS	BY	DATE

THE INSTALLATION DETAILS DESCRIBED HEREIN ARE GENERIC
AND MAY NOT REFLECT ACTUAL CONDITIONS FOR A SPECIFIC
SITE. IF SITE CONDITIONS CAUSE INSTALLATION TO DEVIATE
FROM THE REQUIREMENTS DETAILED HEREIN, A LICENSED
ENGINEER OR ARCHITECT SHALL PREPARE SITE SPECIFIC
DOCUMENTS FOR USE WITH THIS DOCUMENT

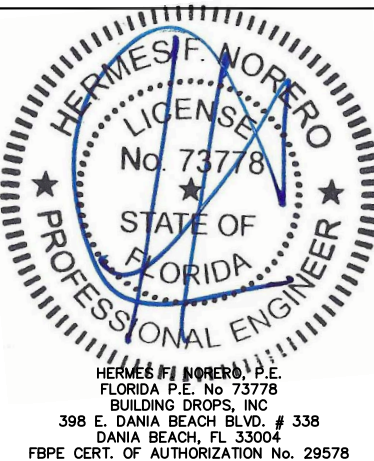

FL #:
FL11517

DATE: **07.03.19**

DWG. BY: **RV** CHK. BY: **HFN**

SCALE: **NTS**

DWG. #: **WWD038**

SHEET:

5

OF 7

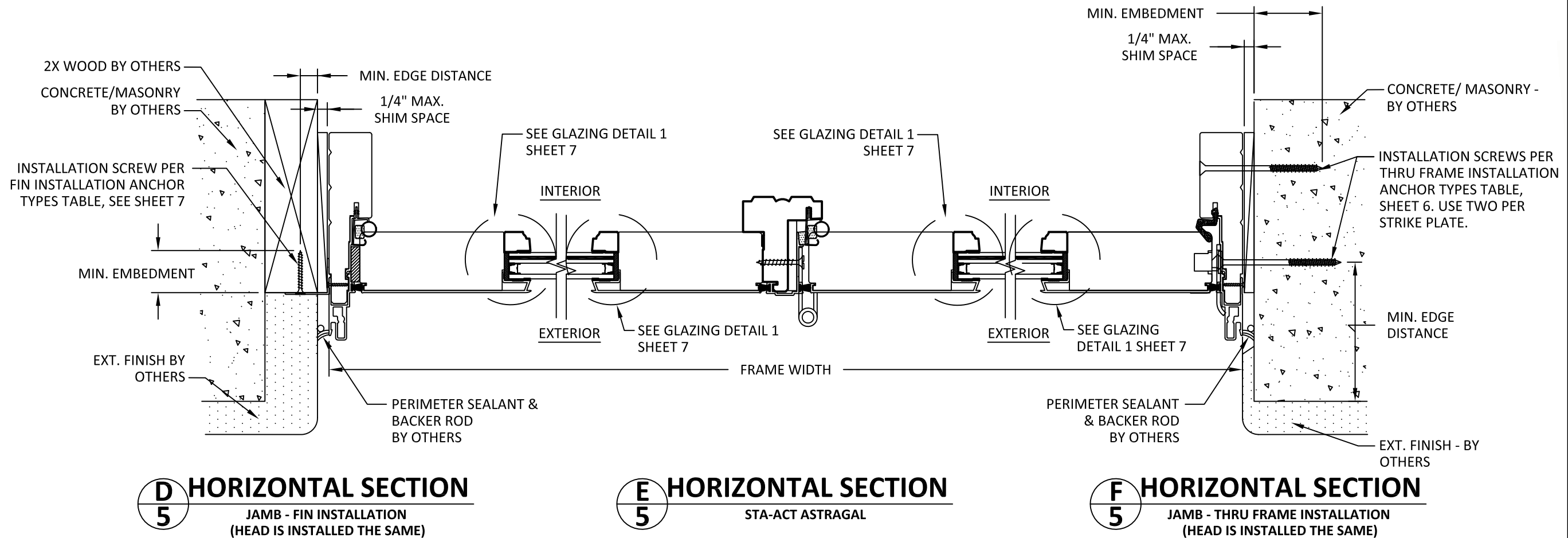
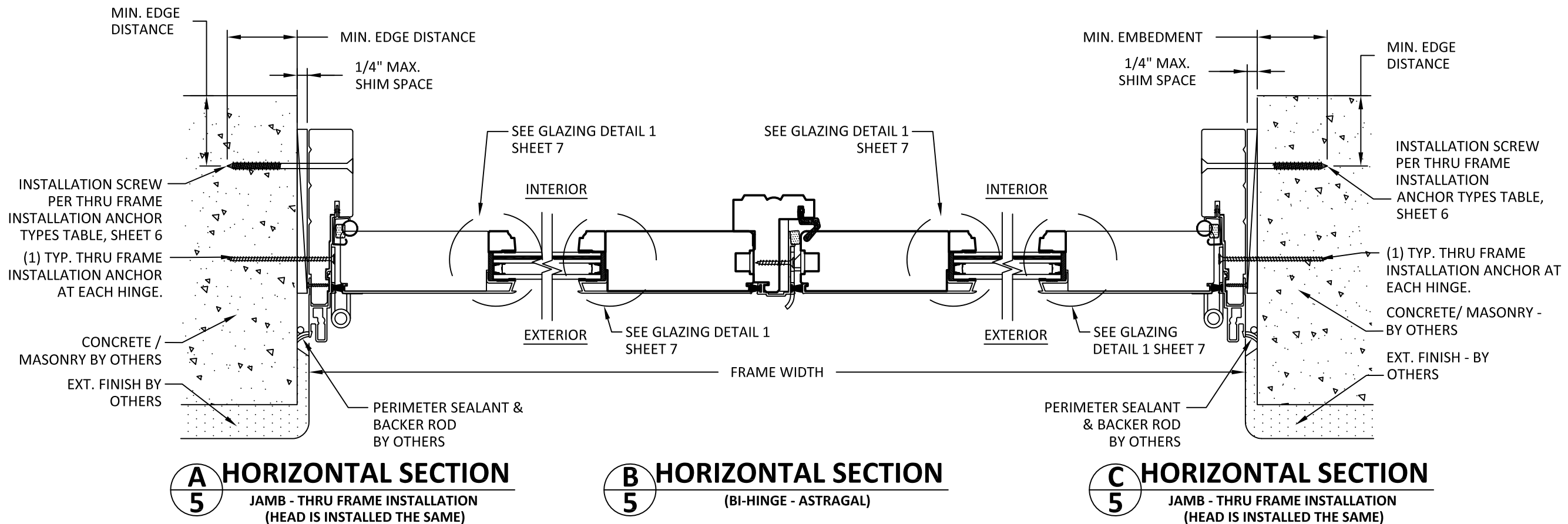

10/28/2019 6:47 PM

s:\projects\windor windows and doors\fbc-18-0516 - pinnacle outswing door\dwgs\wwd038.dwg

CLIP ANCHOR TYPES					
ANCHOR DESCRIPTION	SUBSTRATE REQUIREMENTS	MIN. EMBEDMENT	MIN. EDGE DISTANCE	MAX. SPACING DISTANCE	NOTES
3/16" Ø ULTRACON BY ELCO (F _U =155 KSI , F _y =177 KSI)	CONCRETE AT HEAD, SILL OR JAMBS F' _C =3000 PSI/ MIN. C-90 HOLLOW/FILLED BLOCK AT JAMBS F' _M =2000 PSI/ MIN.	1.75"	1.0"	HEAD: 8" O.C. AND 4" FROM CORNER JAMBS: 8" O.C. AND 4" FROM CORNER SILL: PER THRU FRAME INSTALLATION	MAY BE USED THROUGH OPTIONAL 1X BUCKS, BY OTHERS
#8-24 WOOD SCREWS	MIN. S.G.=0.55 WOOD	1.0"	1.0"	HEAD: 8" O.C. AND 4" FROM CORNER JAMBS: 8" O.C. AND 4" FROM CORNER SILL: PER THRU FRAME INSTALLATION	--
#8-24 SELF-DRILLING OR SELF-TAPPING HWH SCREWS (GRADE 5)	STEEL: 18 GA. MIN., F _y =33 KSI/ MIN. ALUM.: 1/8" MIN., 6063-T5 MIN.	3 THREADS PENETRATION PAST METAL STRUCTURE	0.75"	HEAD: 8" O.C. AND 4" FROM CORNER JAMBS: 8" O.C. AND 4" FROM CORNER SILL: PER THRU FRAME INSTALLATION	STEEL IN CONTACT WITH ALUM. TO BE PLATED OR PAINTED
CLIP FASTENED TO DOOR WOOD FRAME WITH (2) #6 X 3/4" SCREWS PER CLIP					

THRU FRAME ANCHOR TYPES					
ANCHOR DESCRIPTION	SUBSTRATE REQUIREMENTS	MIN. EMBEDMENT	MIN. EDGE DISTANCE	MAX. SPACING DISTANCE	NOTES
3/16" Ø ULTRACON BY ELCO (F _U =155 KSI , F _y =177 KSI)	CONCRETE AT HEAD, SILL OR JAMBS F' _C =3000 PSI/ MIN. C-90 HOLLOW/FILLED BLOCK AT JAMBS F' _M =2000 PSI/ MIN.	1.75"	1.0"	HEAD: 12" O.C. AND 6 FROM CORNER JAMBS: 12" O.C. AND 6 FROM CORNER SILL: 12" O.C. AND 6 FROM CORNER	MAY BE USED THROUGH OPTIONAL 1X BUCKS, BY OTHERS
#10-24 WOOD SCREWS	MIN. S.G.= 0.55 WOOD	1.0"	0.75"	HEAD: 12" O.C. AND 6 FROM CORNER JAMBS: 12" O.C. AND 6 FROM CORNER SILL: 12" O.C. AND 6 FROM CORNER	--
#10-24 SELF-DRILLING OR SELF-TAPPING HWH SCREWS (GRADE 5)	STEEL: 18 GA. MIN., F _y =33 KSI/ MIN. ALUM.: 1/8" MIN., 6063-T5 MIN.	3 THREADS PENETRATION PAST METAL STRUCTURE	0.75"	HEAD: 12" O.C. AND 6 FROM CORNER JAMBS: 12" O.C. AND 6 FROM CORNER SILL: 12" O.C. AND 6 FROM CORNER	STEEL IN CONTACT WITH ALUM. TO BE PLATED OR PAINTED

FIN INSTALLATION ANCHOR TYPES					
ANCHOR DESCRIPTION	SUBSTRATE REQUIREMENTS	MIN. EMBEDMENT	MIN. EDGE DISTANCE	MAX. SPACING DISTANCE	NOTES
#8 WOOD SCREWS	MIN. S.G.=0.55 WOOD	1.5"	0.5"	HEAD: 8" O.C. AND 4" FROM CORNER JAMBS: 8" O.C. AND 4" FROM CORNER SILL: PER THRU FRAME INSTALLATION	--
#8-24 SELF-DRILLING OR SELF-TAPPING HWH SCREWS (GRADE 5)	STEEL: 18 GA. MIN., F _y =33 KSI/ MIN. ALUM.: 1/8" MIN., 6063-T5 MIN.	3 THREADS PENETRATION PAST METAL STRUCTURE	0.5"	HEAD: 8" O.C. AND 4" FROM CORNER JAMBS: 8" O.C. AND 4" FROM CORNER SILL: PER THRU FRAME INSTALLATION	STEEL IN CONTACT WITH ALUM. TO BE PLATED OR PAINTED
FIN IS FASTENED TO DOOR FRAME WITH #8 X 1/2" SCREWS AT 8" O.C. SEE ELEVATIONS FOR ADDITIONAL THROUGH FRAME SCREW REQUIREMENTS AT HEAD AND SILL					

ANCHOR NOTES:

PINNACLE CLAD OS BI-HINGE DOOR
-USE ONE THRU FRAME INSTALLATION ANCHOR PER HINGE
-USE FOUR THRU FRAME INSTALLATION ANCHORS THRU HEAD STRIKE PLATE AND REINFORCEMENT FOR CLIP AND THROUGH FRAME INSTALLATION (NOT REQUIRED FOR NAIL FIN)
-INSTALL ANCHORS THROUGH HARDWARE LOCATIONS WITH SPECIFIED EMBEDMENT AND EDGE DISTANCE INTO WALL

PINNACLE CLAD OS ACTIVE-STATIONARY DOOR
-USE TWO THRU FRAME INSTALLATION ANCHORS THRU HEAD STRIKE PLATE FOR CLIP AND THROUGH FRAME INSTALLATION (NOT REQUIRED FOR NAIL FIN)
-USE TWO THRU FRAME INSTALLATION ANCHORS THRU JAMB STRIKE PLATES
-INSTALL ANCHORS THROUGH HARDWARE LOCATIONS WITH SPECIFIED EMBEDMENT AND EDGE DISTANCE INTO WALL



WINDSOR WINDOWS & DOORS

900 S. 19TH STREET.
WEST DES MOINES, IA 50265
PH: (515)223-6660 FAX: (515)224-1938

PINNACLE CLAD IMPACT
OUTSWING DOOR (HVHZ)
ANCHOR SCHEDULE

TITLE:

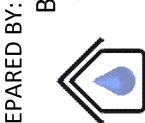

BUILDING DROPS, INC.
398 E. DANIA BEACH BLVD., STE. 338
DANIA BEACH, FL 33004
PH: (954)399-8478
FAX: (954)744-4738
WEB: www.buildingdrops.com

PREPARED BY:

REMARKS	BY	DATE

THE INSTALLATION DETAILS DESCRIBED HEREIN ARE GENERIC AND MAY NOT REFLECT ACTUAL CONDITIONS FOR A SPECIFIC SITE. IF SITE CONDITIONS CAUSE INSTALLATION TO DEVIATE FROM THE REQUIREMENTS DETAILED HEREIN, A LICENSED ENGINEER OR ARCHITECT SHALL PREPARE SITE SPECIFIC DOCUMENTS FOR USE WITH THIS DOCUMENT

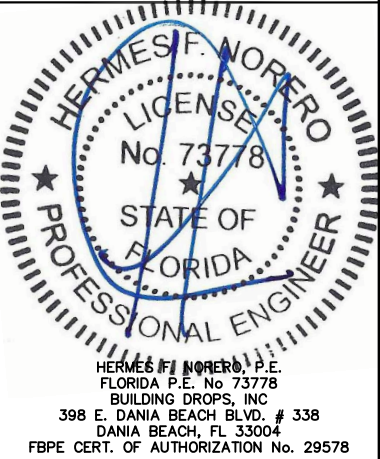

FL #:

FL11517

DATE: 07.03.19

DWG. BY:
RV

CHK. BY:
HFN

SCALE: NTS

DWG. #: WWD038

SHEET:

6



WINDSOR WINDOWS
& DOORS

900 S. 19TH STREET.
WEST DES MOINES, IA 50265
PH: (515)223-6660 FAX: (515)224-1938

PINNACLE CLAD IMPACT
OUTSWING DOOR (HVHZ)
GLAZING DETAILS
AND HARDWARE DETAILS

PREPARED BY:
BUILDING DROPS, INC.

398 E. DANIA BEACH BLVD., STE. 338
DANIA BEACH, FL 33004
PH: (954)399-8478
FAX: (954)744-4738
WEB: www.buildingdrops.com



TITLE:

REMARKS	BY	DATE

THE INSTALLATION DETAILS DESCRIBED HEREIN ARE GENERIC
AND MAY NOT REFLECT ACTUAL CONDITIONS FOR A SPECIFIC
SITE. IF SITE CONDITIONS CAUSE INSTALLATION TO DEVIATE
FROM THE REQUIREMENTS DETAILED HEREIN, A LICENSED
ENGINEER OR ARCHITECT SHALL PREPARE SITE SPECIFIC
DOCUMENTS FOR USE WITH THIS DOCUMENT



FL #:
FL11517

DATE: **07.03.19**

DWG. BY: **RV** CHK. BY: **HFN**

SCALE: **NTS**

DWG. #: **WWD038**

SHEET:
7

OF 7

3/4" O.A. THICKNESS INSULATED
LAMINATED GLASS CONSISTING OF:
1/8" TEMPERED GLASS
5/16" DESICCANT FILLED STEEL SPACER
1/8" ANNEALED GLASS
8.6mm LAMINATED SGP INTERLAYER
1/8" ANNEALED GLASS

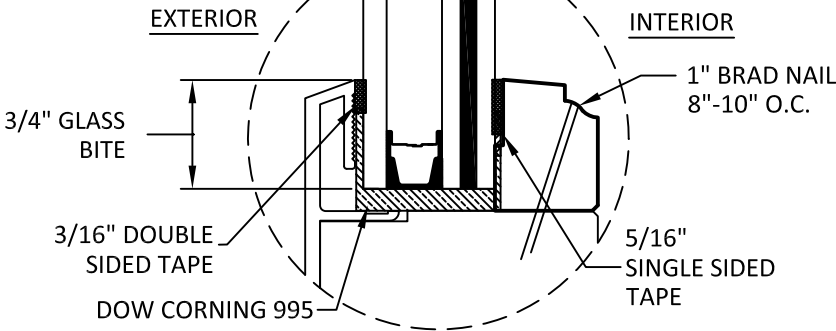

GLAZING DETAIL 1

LAMINATED CORE
W/ CLEAR CAROLINA
PINE VENEER
ON INTERIOR
0.016 WHITE CABINET BACKING
0.0625 PINE VANNER

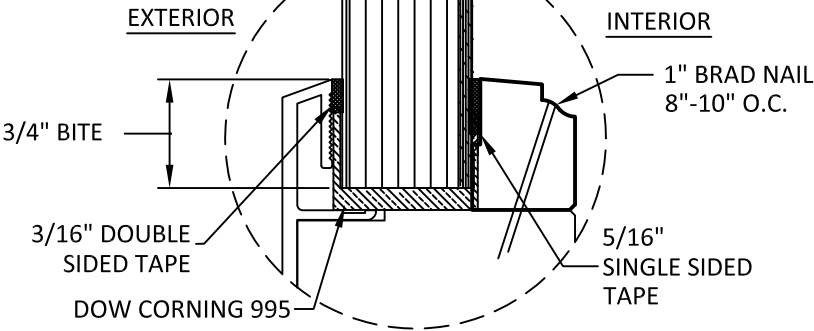

PANEL DETAIL 1

GLASS NOTES:

- GLASS THICKNESS AND TYPE COMPLIES WITH ASTM E 1300 REQUIREMENT
GLASS CHARTS AND FLORIDA BUILDING CODE CHAPTER 24 SAFETY GLAZING
REQUIREMENTS

HARDWARE NOTES:

PINNACLE CLAD OS BI-HINGE DOOR

(4) ADJUSTABLE HINGES INTO ASTRAGAL AT 7", 32-1/2", 57 1/2" & 83-1/2" FROM THE
THRESHOLD. ACTIVE PANEL FIVE-POINT LOCKING SYSTEM WITH ENGAGEMENT
POINTS AT 7", 38" & 74" ABOVE THE THRESHOLD WITH SHOOT BOLTS AT HEAD
AND SILL. DEADBOLT LOCATED 34" ABOVE THE THRESHOLD. SPACING BETWEEN
LOCK POINTS AND HINGES NOT TO BE EXCEEDED FOR ALTERNATE SIZES.
SECONDARY ACTIVE PANEL WITH LEVER ACTIVATED SHOOT BOLTS AT HEAD AND
SILL.

PINNACLE CLAD OS ACTIVE-STATIONARY DOOR

(4) ADJUSTABLE HINGES INTO ASTRAGAL AT 7", 32-1/2", 57 1/2" & 83-1/2" FROM THE
THRESHOLD. ACTIVE PANEL MULTI-POINT LOCKING SYSTEM WITH ENGAGEMENT
POINTS AT 7", 38" & 74" ABOVE THE THRESHOLD WITH SHOOT BOLTS AT HEAD
AND SILL. DEAD BOLT LOCATED 34" ABOVE THE THRESHOLD. SPACING BETWEEN
LOCK POINTS AND HINGES NOT TO BE EXCEEDED FOR ALTERNATE SIZES.