

5/20/2019 11:22 AM

s:\projects\windsor windows and doors\cc-19-0008 - code change (FL11482 in-sash transom window impact-m)\dwgs\wwd045.dwg

INSTALLATION NOTES:

1. ONE (1) INSTALLATION ANCHOR IS REQUIRED AT EACH ANCHOR LOCATION SHOWN.
2. THE NUMBER OF INSTALLATION ANCHORS DEPICTED IS THE MINIMUM NUMBER OF ANCHORS TO BE USED FOR PRODUCT INSTALLATION OF THE MAXIMUM SIZE LISTED.
3. INSTALL INDIVIDUAL INSTALLATION ANCHORS WITHIN A TOLERANCE OF ±1/2 INCH BASED ON QUANTITIES IN DP CHARTS NOT TO EXCEED THE DEPICTED LOCATION & SPACING IN THE ANCHOR LAYOUT DETAILS (I.E., WITHOUT CONSIDERATION OF TOLERANCES). TOLERANCES ARE NOT CUMULATIVE FROM ONE INSTALLATION ANCHOR TO THE NEXT
4. SHIM AS REQUIRED AT EACH INSTALLATION ANCHOR WITH LOAD BEARING SHIM(S). MAXIMUM ALLOWABLE SHIM STACK TO BE 1/4 INCH. SHIM WHERE SPACE OF 1/16 INCH OR GREATER OCCURS. SHIM(S) SHALL BE CONSTRUCTED OF HIGH DENSITY PLASTIC OR BETTER.
5. **THROUGH FRAME:** FOR INSTALLATION INTO WOOD FRAMING USE #10 WOOD SCREWS OF SUFFICIENT LENGTH TO ACHIEVE 1 1/2" MINIMUM EMBEDMENT INTO WOOD SUBSTRATE.
6. **THROUGH FRAME:** FOR INSTALLATION THROUGH 1X BUCK TO CONCRETE/MASONRY, OR DIRECTLY INTO CONCRETE/MASONRY, USE 1/4" DIAMETER ITW TAPCONS, ELCO ULTRACONS, ELCO CRETE-FLEX OR HILTI KWIK-CON II OF SUFFICIENT LENGTH TO ACHIEVE 1 1/4" MINIMUM EMBEDMENT.
7. **THROUGH FRAME:** FOR INSTALLATION INTO METAL STUD OR APPROVED MULLION USE #10 GR. 5 SELF TAPPING SCREWS OF SUFFICIENT LENGTH TO ACHIEVE A MINIMUM OF 3 THREADS PENETRATION BEYOND METAL FRAME SUBSTRATE.
8. CLIPS SHALL BE FASTENED TO THE WINDOW FRAME WITH (2) #8 X 5/8" SCREWS. CLIPS ARE 20 GAUGE (0.036" THICKNESS) F_y=33 KSI MIN STEEL WITH OVERALL DIMENSIONS OF 1.5" WIDE, 7.813" ALONG THE LONG LEG, AND 1.942" ALONG THE SHORT LEG.
9. **CLIP ANCHOR:** FOR INSTALLATION INTO WOOD FRAMING USE (2) #8 WOOD SCREWS PER CLIP OF SUFFICIENT LENGTH TO ACHIEVE 1 1/2 INCH MINIMUM EMBEDMENT INTO WOOD SUBSTRATE.
10. **CLIP ANCHOR:** FOR INSTALLATION INTO METAL STUD USE (2) #8 GR. 5 SELF-TAPPING SCREWS PER CLIP OF SUFFICIENT LENGTH TO ACHIEVE 3 THREADS MINIMUM PENETRATION BEYOND THE METAL STRUCTURE.
11. 1.5" X 1.5" X 0.060" 6063-T5 ALUMINUM NAIL FIN SHALL BE FASTENED TO THE WINDOW FRAME WITH #8 X 1/2" SCREWS, 8" MAX. ON CENTER AND 4" MAX. FROM CORNERS AT SILL AND JAMBS. HEAD SHALL BE ATTACHED USING CONTINUOUS 3M VHB TAPE.
12. **NAIL FIN:** FOR INSTALLATION INTO WOOD FRAMING USE #8 WOOD SCREWS OF SUFFICIENT LENGTH TO ACHIEVE 1 1/2 INCH MINIMUM EMBEDMENT INTO WOOD SUBSTRATE.
13. **NAIL FIN:** FOR INSTALLATION INTO METAL STUD OR APPROVED MULLION USE #8 GR. 5 SELF TAPPING SCREWS OF SUFFICIENT LENGTH TO ACHIEVE A MINIMUM OF 3 THREADS PENETRATION BEYOND METAL FRAME SUBSTRATE.
14. MINIMUM EMBEDMENT AND EDGE DISTANCE EXCLUDE WALL FINISHES, INCLUDING BUT NOT LIMITED TO STUCCO, FOAM, BRICK VENEER, AND SIDING.
15. INSTALLATION ANCHORS AND ASSOCIATED HARDWARE MUST BE MADE OF CORROSION RESISTANT MATERIAL OR HAVE A CORROSION RESISTANT COATING.
16. FOR GROUT FILLED BLOCK, DO NOT INSTALL INSTALLATION ANCHORS INTO MORTAR JOINTS. EDGE DISTANCE IS MEASURED FROM FREE EDGE OF BLOCK OR EDGE OF MORTAR JOINT INTO FACE SHELL OF BLOCK.
17. INSTALLATION ANCHORS SHALL BE INSTALLED IN ACCORDANCE WITH ANCHOR MANUFACTURER'S INSTALLATION INSTRUCTIONS, AND ANCHORS SHALL NOT BE USED IN SUBSTRATES WITH STRENGTHS LESS THAN THE MINIMUM STRENGTH SPECIFIED BY THE ANCHOR MANUFACTURER.

WINDSOR WINDOWS & DOORS

PINNACLE CLAD DOOR TRANSOM IN SASH

(IMPACT) (HVHZ)

CONTINUED INSTALLATION NOTES:

18. INSTALLATION ANCHOR CAPACITIES FOR PRODUCTS HEREIN ARE BASED ON SUBSTRATE MATERIALS WITH THE FOLLOWING PROPERTIES:

A. WOOD - MINIMUM SPECIFIC GRAVITY OF 0.55.

B. CONCRETE -MINIMUM COMPRESSIVE STRENGTH OF 3000 PSI.

C. GROUT-FILLED CMU- UNIT STRENGTH CONFORMS TO ASTM C-90 WITH MINIMUM COMPRESSIVE STRENGTH OF 2000 PSI AND GROUT CONFORMS TO ASTM C 476, MINIMUM GROUT COMPRESSIVE STRENGTH OF 2000 PSI.

D. STEEL - MINIMUM YIELD STRENGTH OF 33 KSI. MINIMUM 18 GA. WALL THICKNESS.

E. ALUMINUM - MINIMUM ALLOY 6063-T5. MINIMUM WALL THICKNESS OF 1/8" (0.125").

GENERAL NOTES:

1. THE PRODUCT SHOWN HEREIN IS DESIGNED AND MANUFACTURED TO COMPLY WITH THE CURRENT FLORIDA BUILDING CODE (FBC), INCLUDING HVHZ AND HAS BEEN EVALUATED ACCORDING TO THE FOLLOWING:

AAMA/WDMA/CSA 101/I.S.2/A440-17

ASTM E1886-13

ASTM E1996-14

TAS 201-94

TAS 202-94

TAS 203-94
2. ADEQUACY OF THE EXISTING STRUCTURAL CONCRETE/MASONRY AND 2X FRAMING AS A MAIN WIND FORCE RESISTING SYSTEM CAPABLE OF WITHSTANDING AND TRANSFERRING APPLIED PRODUCT LOADS TO THE FOUNDATION IS THE RESPONSIBILITY OF THE ENGINEER OR ARCHITECT OF RECORD FOR THE PROJECT OF INSTALLATION.
3. 1X AND 2X BUCKS (WHEN USED) SHALL BE DESIGNED AND ANCHORED TO PROPERLY TRANSFER ALL LOADS TO THE STRUCTURE. BUCK DESIGN AND INSTALLATION IS THE RESPONSIBILITY OF THE ENGINEER OR ARCHITECT OF RECORD FOR THE PROJECT OF INSTALLATION.
4. THE INSTALLATION DETAILS DESCRIBED HEREIN ARE GENERIC AND MAY NOT REFLECT ACTUAL CONDITIONS FOR A SPECIFIC SITE. IF SITE CONDITIONS CAUSE INSTALLATION TO DEVIATE FROM THE REQUIREMENTS DETAILED HEREIN, A LICENSED ENGINEER OR ARCHITECT SHALL PREPARE SITE SPECIFIC DOCUMENTS FOR USE WITH THIS DOCUMENT.
5. APPROVED IMPACT PROTECTIVE SYSTEM IS NOT REQUIRED ON THIS PRODUCT IN AREAS REQUIRING IMPACT RESISTANCE.
6. WINDOW FRAME MATERIAL: WOOD
WINDOW CLADDING MATERIAL: ALUMINUM 6063-T5
7. GLASS MEETS THE REQUIREMENTS OF ASTM E 1300 GLASS CHARTS. SEE SHEET 2 FOR GLAZING DETAILS.

TABLE OF CONTENTS	
SHEET	SHEET DESCRIPTION
1	INSTALLATION & GENERAL NOTES
2	ELEVATIONS, ANCHOR LAYOUTS & GLAZING DETAILS
3	NAIL FIN INSTALLATION SECTIONS
4	THROUGH FRAME INSTALLATION SECTIONS
5	CLIP INSTALLATION SECTIONS
6	MULLION INSTALLATION SECTIONS

DESIGN PRESSURE TABLE					
TYP. OVERALL SIZE		DESIGN PRESSURE	CONFIGURATION	INSTALLATION METHOD	IMPACT RATING
WIDTH	HEIGHT				
75"	24"	+50/-65 PSF	O-O	CLIP, THROUGH FRAME OR NAIL FIN	LARGE MISSILE IMPACT MISSILE LEVEL D - WZ4



WINDSOR WINDOWS & DOORS

900 S. 19TH STREET.
WEST DES MOINES, IA 50265
PH: (515)223-6660 FAX: (515)224-1938

TITLE:
PINNACLE CLAD DOOR TRANSOM
IN SASH (IMPACT) (HVHZ)
INSTALLATION
AND GENERAL NOTES

PREPARED BY:
BUILDING DROPS, INC.
398 E. DANIA BEACH BLVD., STE. 338
DANIA BEACH, FL 33004
PH: (954)399-8478
FAX: (954)744-4738
WEB: www.buildingdrops.com

REMARKS	BY	DATE

THE INSTALLATION DETAILS DESCRIBED HERE IN ARE GENERIC AND MAY NOT REFLECT ACTUAL CONDITIONS FOR A SPECIFIC SITE. IF SITE CONDITIONS CAUSE INSTALLATION TO DEVIATE FROM THE REQUIREMENTS DETAILED HEREIN, A LICENSED ENGINEER OR ARCHITECT SHALL PREPARE SITE SPECIFIC DOCUMENTS FOR USE WITH THIS DOCUMENT.

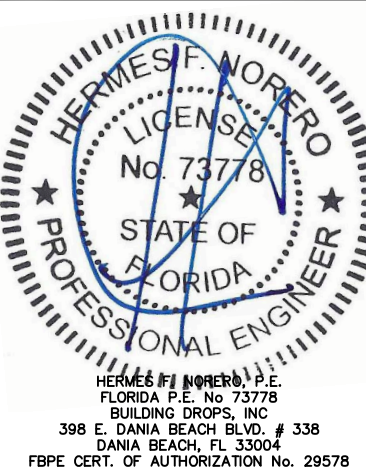

FL #:

FL11482

DATE: 05.03.19

DWG. BY: SM

CHK. BY: HFN

SCALE: NTS

DWG. #: WWD045

SHEET:

1

OF 6



WINDSOR WINDOWS
& DOORS
900 S. 19TH STREET.
WEST DES MOINES, IA 50265
PH: (515)223-6660 FAX: (515)224-1938

TITLE:
PINNACLE CLAD DOOR TRANSOM
IN SASH (IMPACT) (HVHZ)
ELEVATIONS, ANCHOR LAYOUT
& GLAZING DETAIL

PREPARED BY:
BUILDING DROPS, INC.
398 E. DANIA BEACH BLVD., STE. 338
DANIA BEACH, FL 33004
PH: (954)399-8478
FAX: (954)744-4738
WEB: www.buildingdrops.com

REMARKS	BY	DATE

THE INSTALLATION DETAILS DESCRIBED HERE IN ARE GENERIC AND MAY NOT REFLECT ACTUAL CONDITIONS FOR A SPECIFIC SITE. IF SITE CONDITIONS CAUSE INSTALLATION TO DEVIATE FROM THE REQUIREMENTS DETAILED HEREIN, A LICENSED ENGINEER OR ARCHITECT SHALL PREPARE SITE SPECIFIC DOCUMENTS FOR USE WITH THIS DOCUMENT.

HERMES F. NORERO, P.E.
FLORIDA P.E. No. 73778
BUILDING DROPS, INC
398 E. DANIA BEACH BLVD. # 338
DANIA BEACH, FL 33004
FBPE CERT. OF AUTHORIZATION No. 29578

FL #:	FL11482
DATE:	05.03.19
DWG. BY:	SM
CHK. BY:	HFN
SCALE:	NTS
DWG. #:	WWD045
SHEET:	2

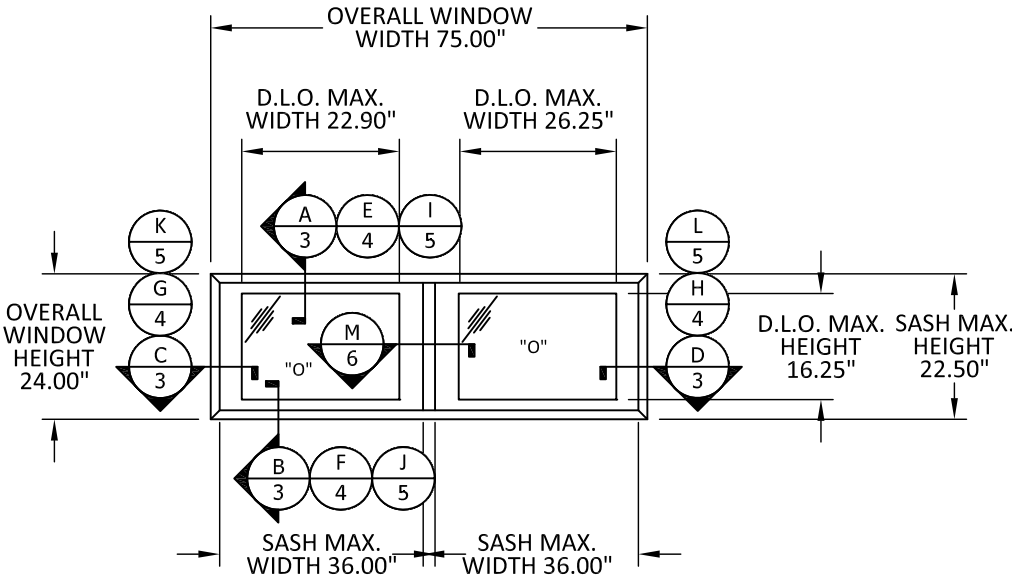

TYPICAL ELEVATION

PINNACLE CLAD DOOR TRANSOM IN SASH

NOTE: MAXIMUM CERTIFIED SIZE SHOWN, SMALLER UNITS AND CONFIGURATIONS ARE QUALIFIED.

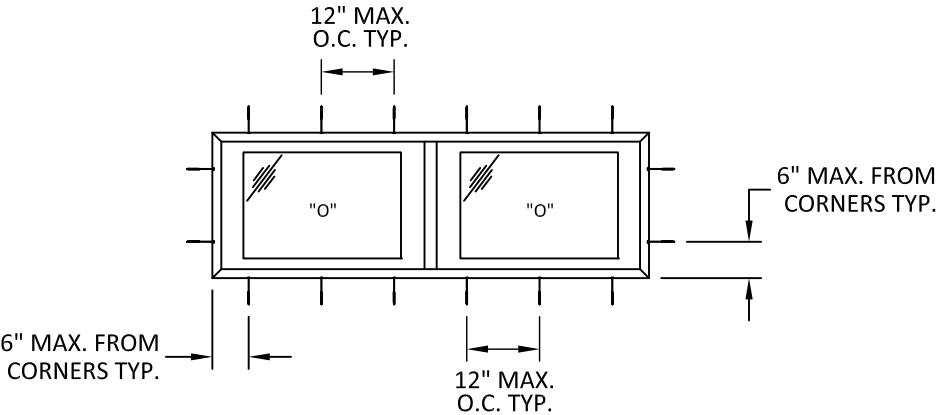

ANCHOR LAYOUT

CLIP OR THROUGH FRAME INSTALLATION

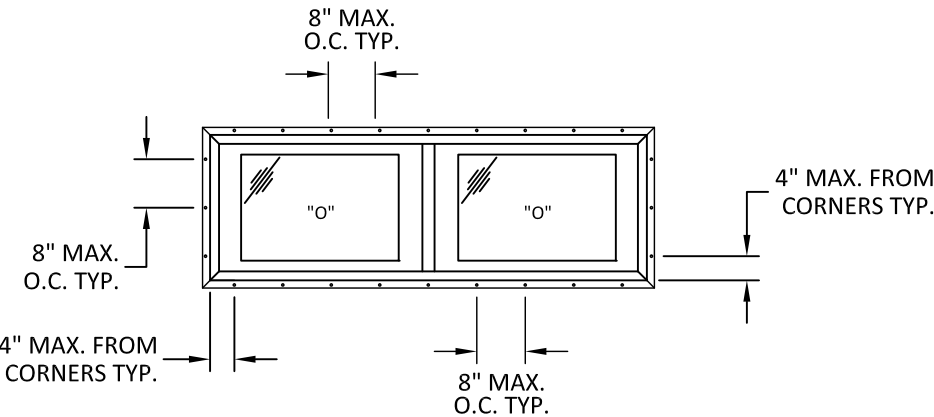

ANCHOR LAYOUT

NAIL FIN INSTALLATION

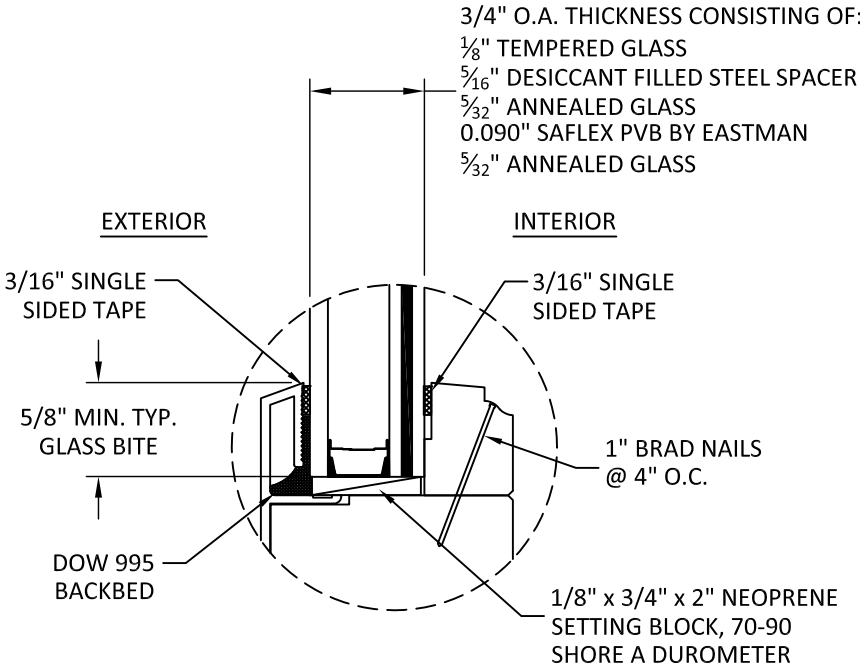

GLAZING DETAIL

- NOTES:
- GLASS THICKNESS AND TYPE COMPLIES WITH ASTM E1300 REQUIREMENT GLASS CHARTS AND ALL APPLICABLE SAFETY GLAZING REQUIREMENTS AS REQUIRED IN FBC CHAPTER 24.

TITLE: PINNACLE CLAD DOOR TRANSOM
IN SASH (IMPACT) (HVHZ)

NAIL FIN INSTALLATION SECTIONS

PREPARED BY: BUILDING DROPS, INC.

398 E. DANIA BEACH BLVD., STE. 338
DANIA BEACH, FL 33004
PH: (954)399-8478
FAX: (954)744-4738
WEB: www.buildingdrops.com



REMARKS	BY	DATE

THE INSTALLATION DETAILS DESCRIBED HEREIN ARE GENERIC
AND MAY NOT REFLECT ACTUAL CONDITIONS FOR A SPECIFIC
SITE. IF SITE CONDITIONS CAUSE INSTALLATION TO DEVIATE
FROM THE REQUIREMENTS DETAILED HEREIN, A LICENSED
ENGINEER OR ARCHITECT SHALL PREPARE SITE SPECIFIC
DOCUMENTS FOR USE WITH THIS DOCUMENT.

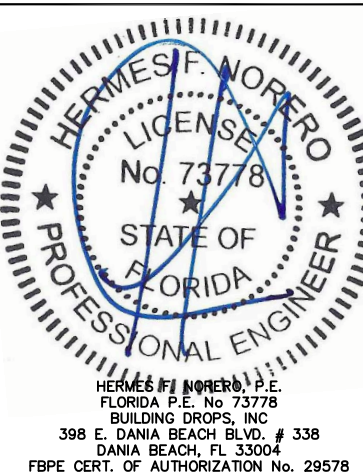

FL #:

FL11482

DATE: 05.03.19

DWG. BY: SM CHK. BY: HFN

SCALE: NTS

DWG. #: WWD045

SHEET:

3

OF 6

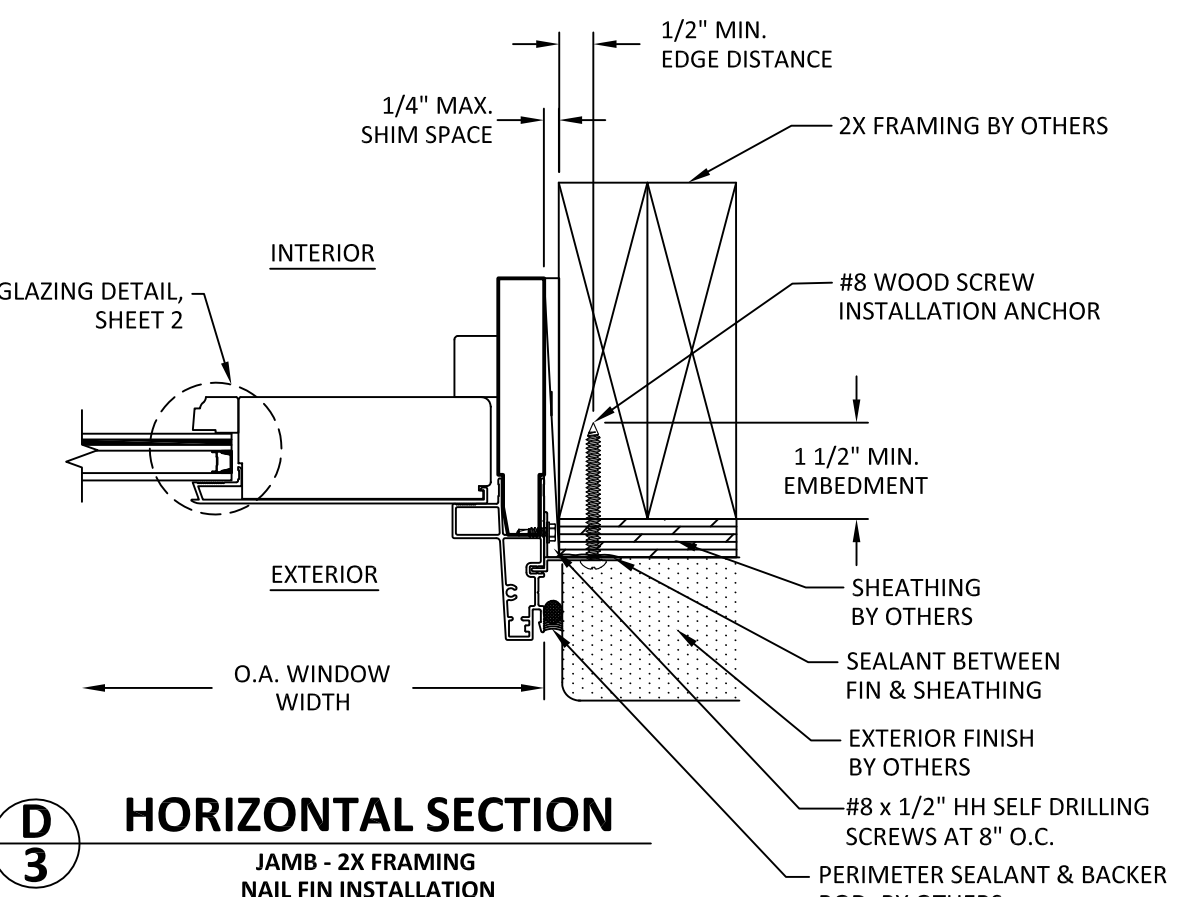
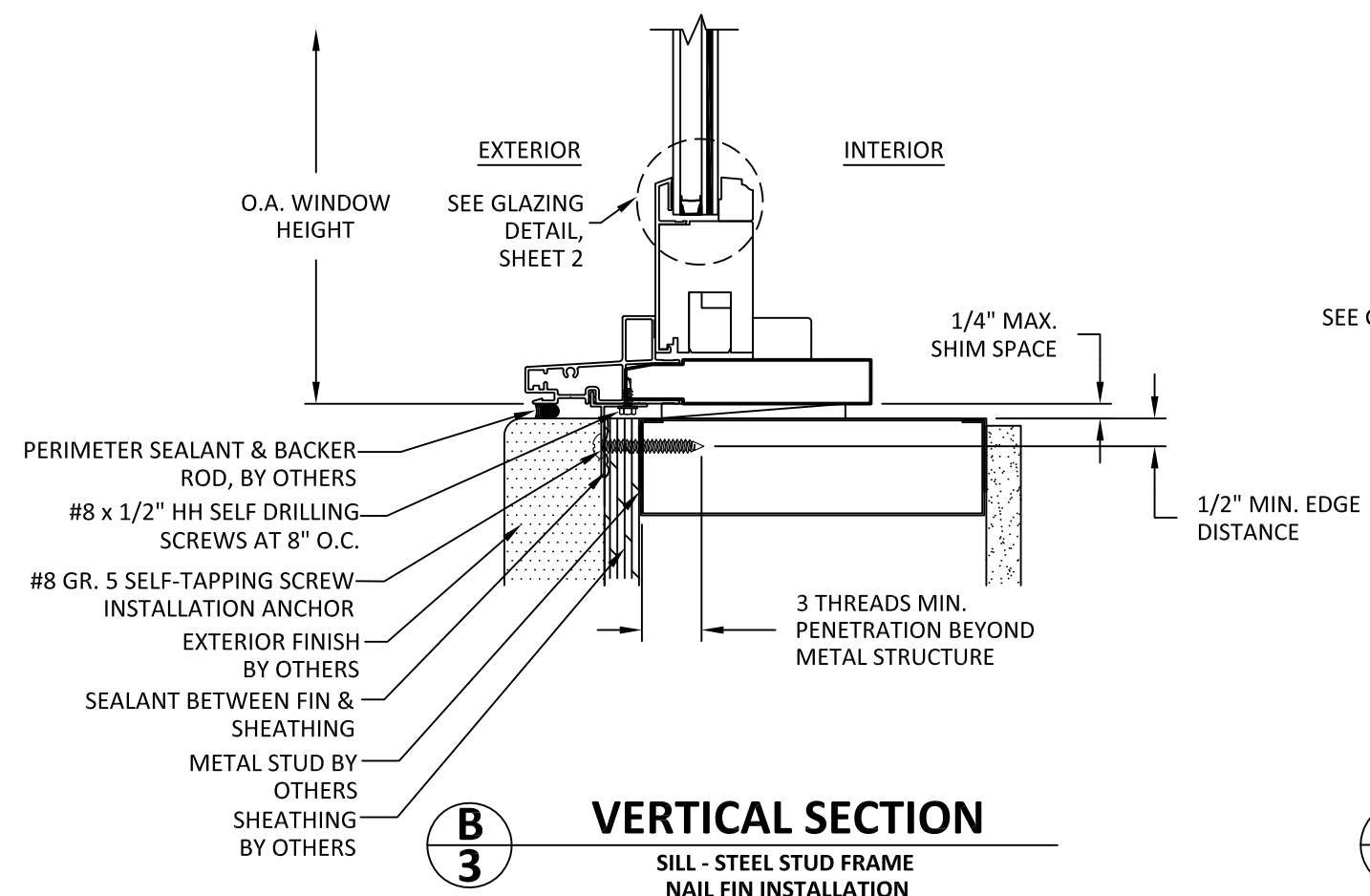
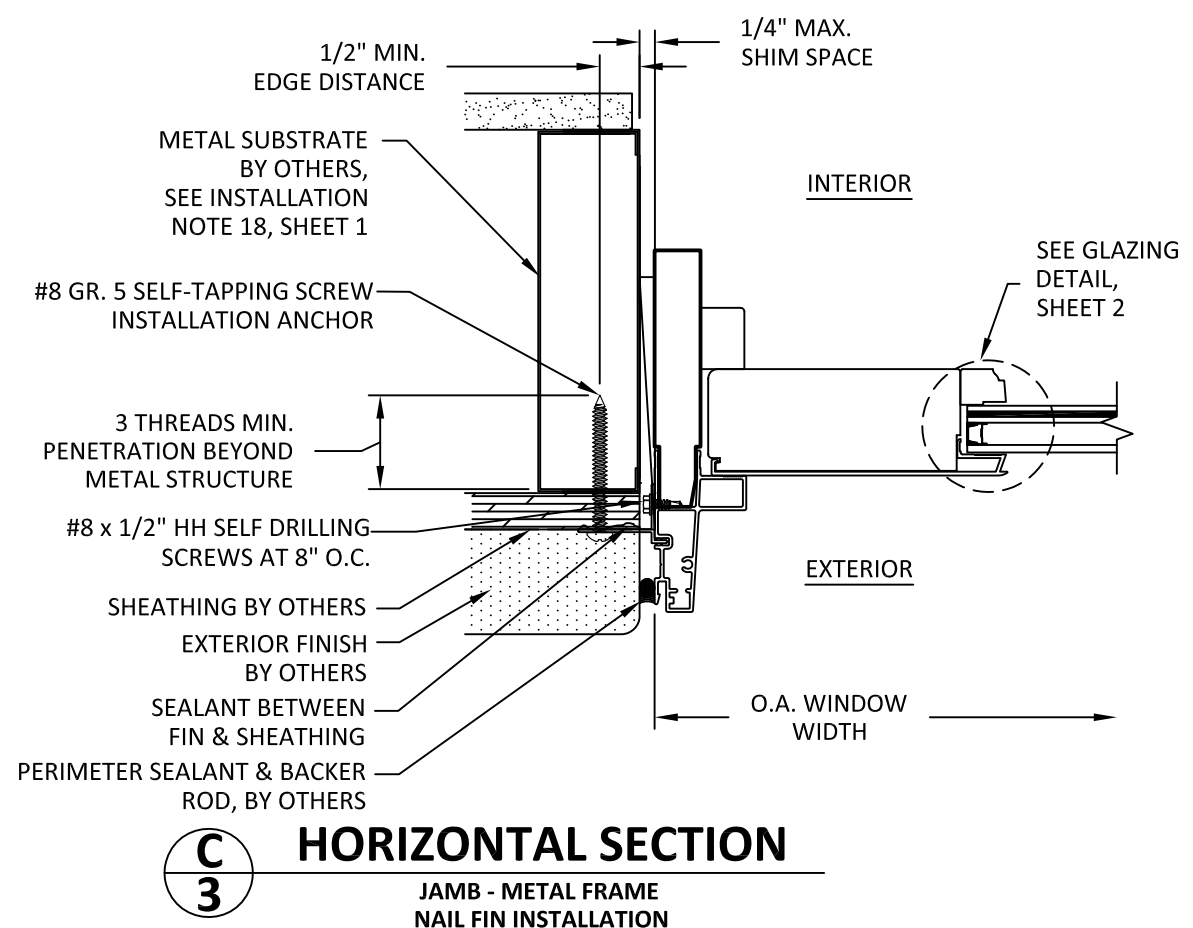
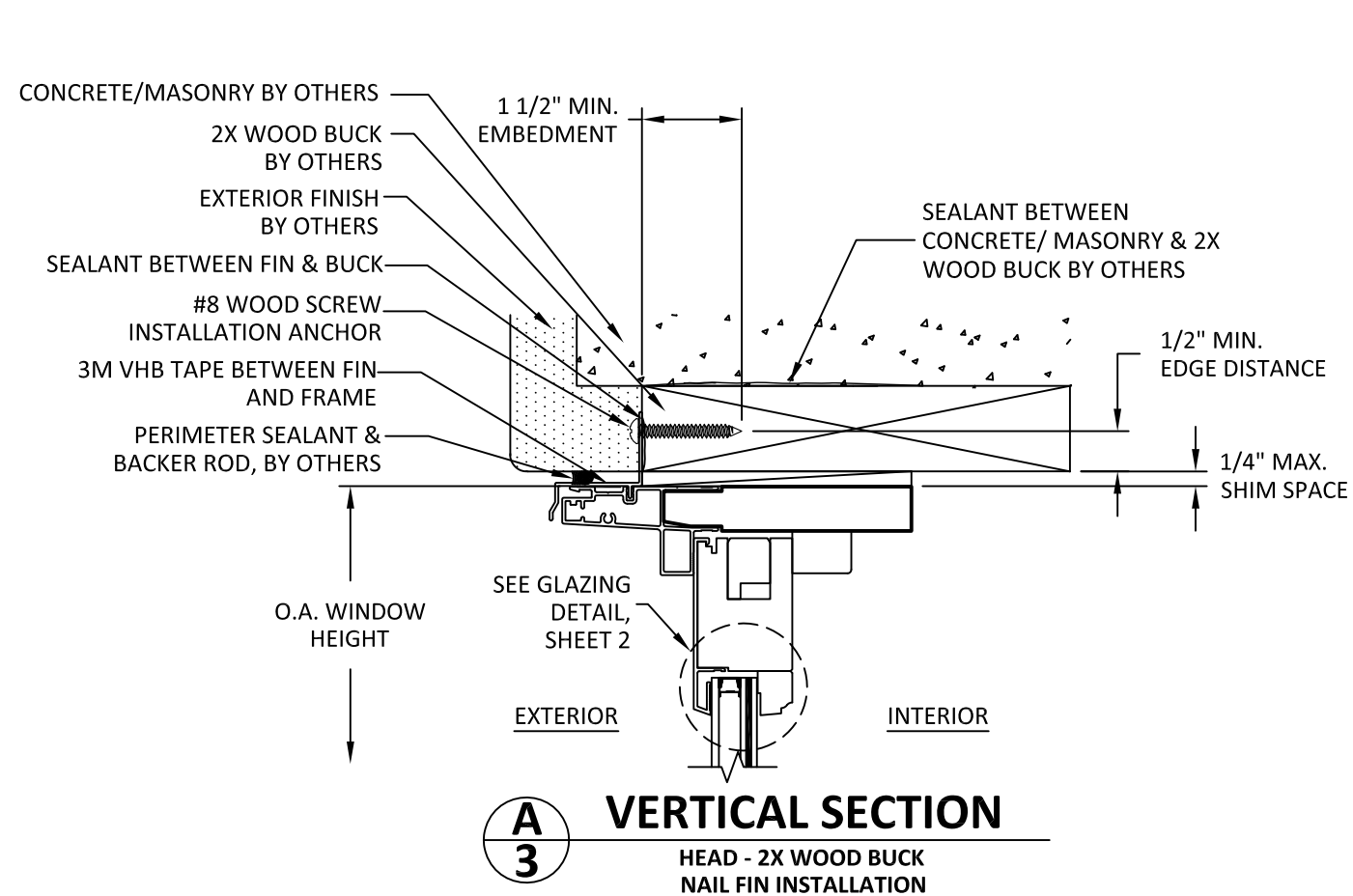

TITLE: PINNACLE CLAD DOOR TRANSOM
IN SASH (IMPACT) (HVHZ)

THROUGH FRAME
INSTALLATION SECTIONS

PREPARED BY: BUILDING DROPS, INC.

398 E. DANIA BEACH BLVD., STE. 338
DANIA BEACH, FL 33004
PH: (954)399-8478
FAX: (954)744-4738
WEB: www.buildingdrops.com



REMARKS	BY	DATE

THE INSTALLATION DETAILS DESCRIBED HEREIN ARE GENERIC
AND MAY NOT REFLECT ACTUAL CONDITIONS FOR A SPECIFIC
SITE. IF SITE CONDITIONS CAUSE INSTALLATION TO DEVIATE
FROM THE REQUIREMENTS DETAILED HEREIN, A LICENSED
ENGINEER OR ARCHITECT SHALL PREPARE SITE SPECIFIC
DOCUMENTS FOR USE WITH THIS DOCUMENT.

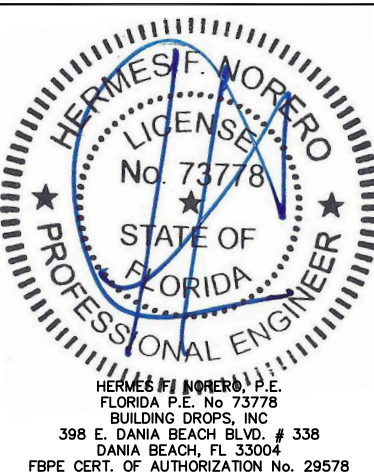

FL #:
FL11482

DATE: **05.03.19**

DWG. BY: **SM** CHK. BY: **HFN**

SCALE: **NTS**

DWG. #: **WWD045**

SHEET:
4

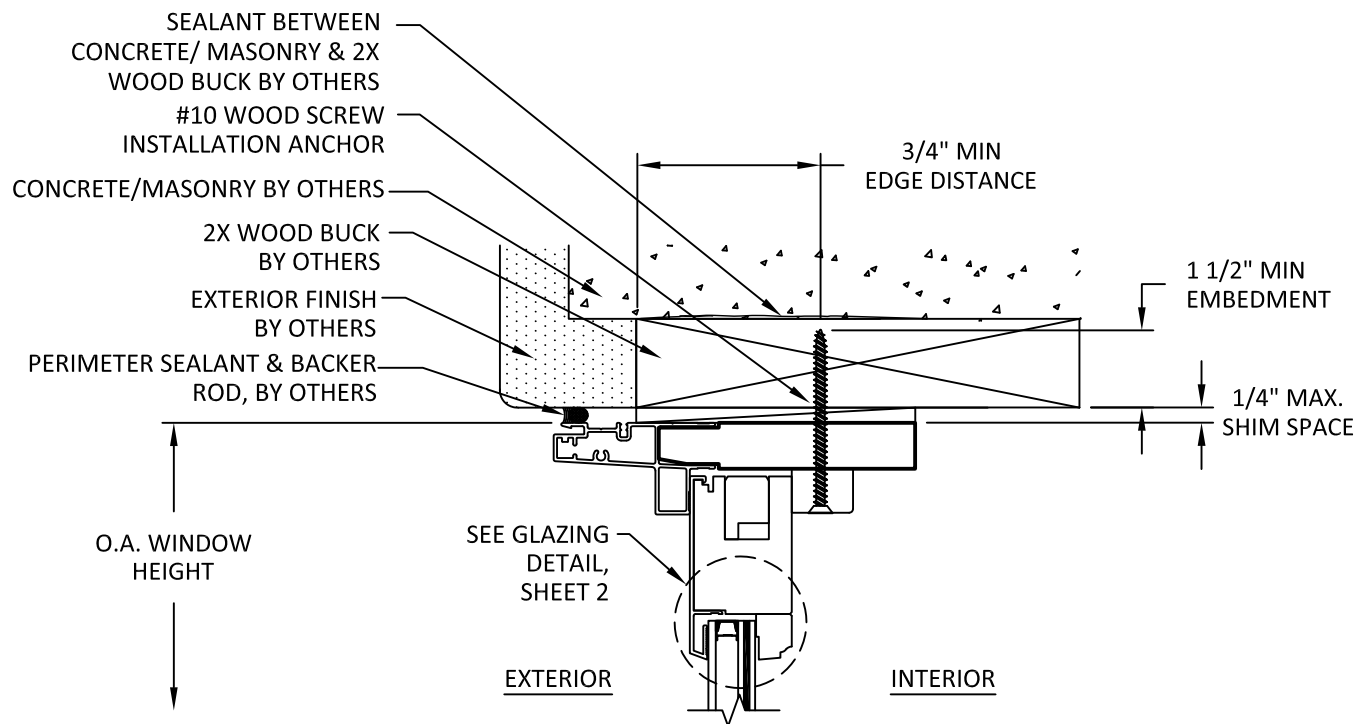

E
4 **VERTICAL SECTION**
HEAD - 2X WOOD BUCK
THROUGH FRAME INSTALLATION

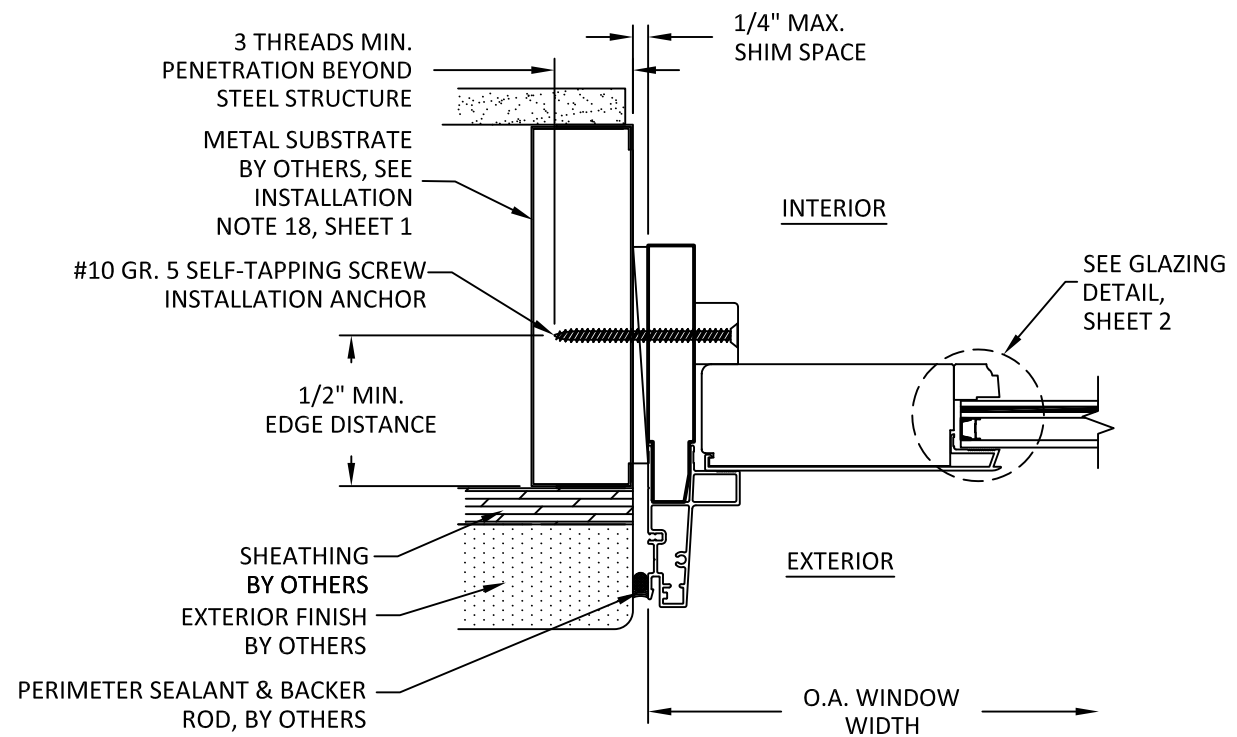

G
4 **HORIZONTAL SECTION**
JAMB - METAL STUD FRAME
THROUGH FRAME INSTALLATION

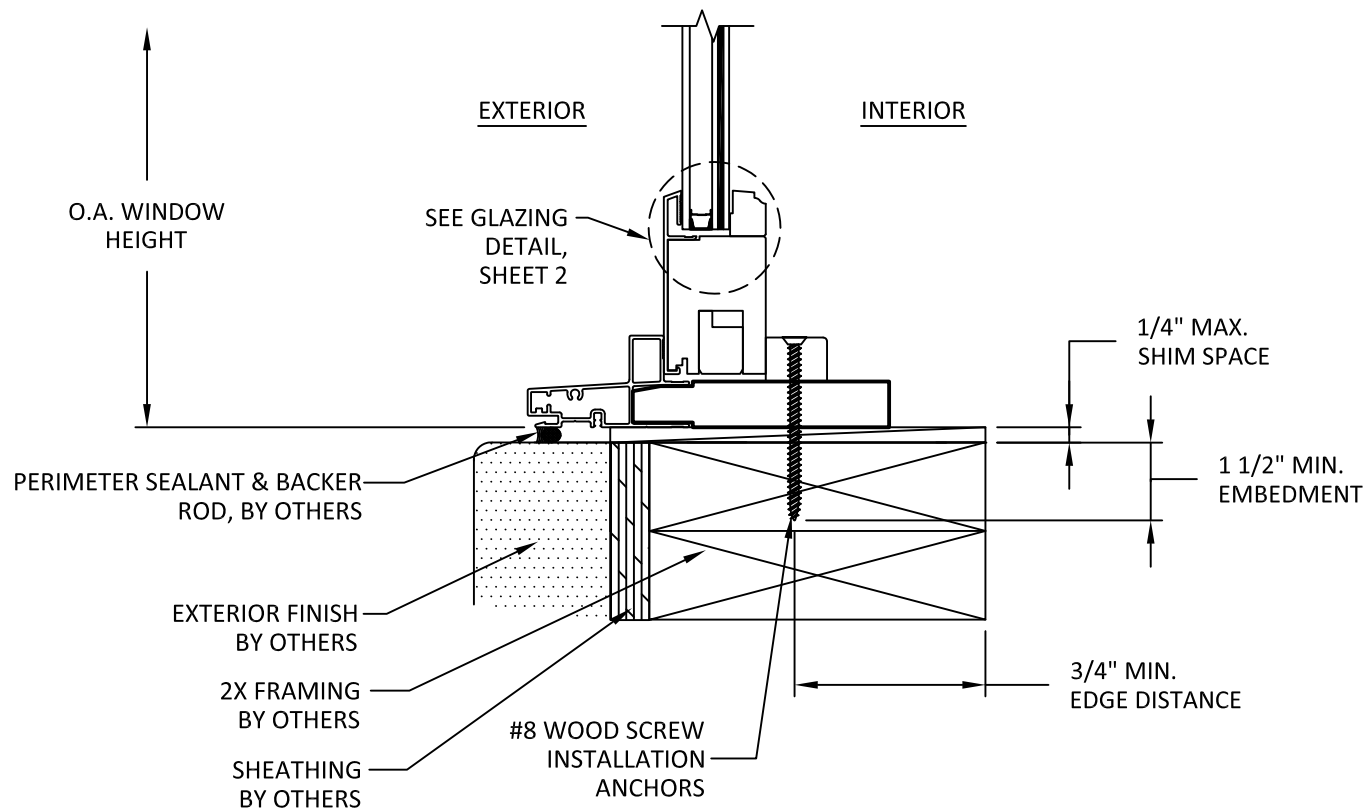

F
4 **VERTICAL SECTION**
SILL - 2X FRAMING
THROUGH FRAME INSTALLATION

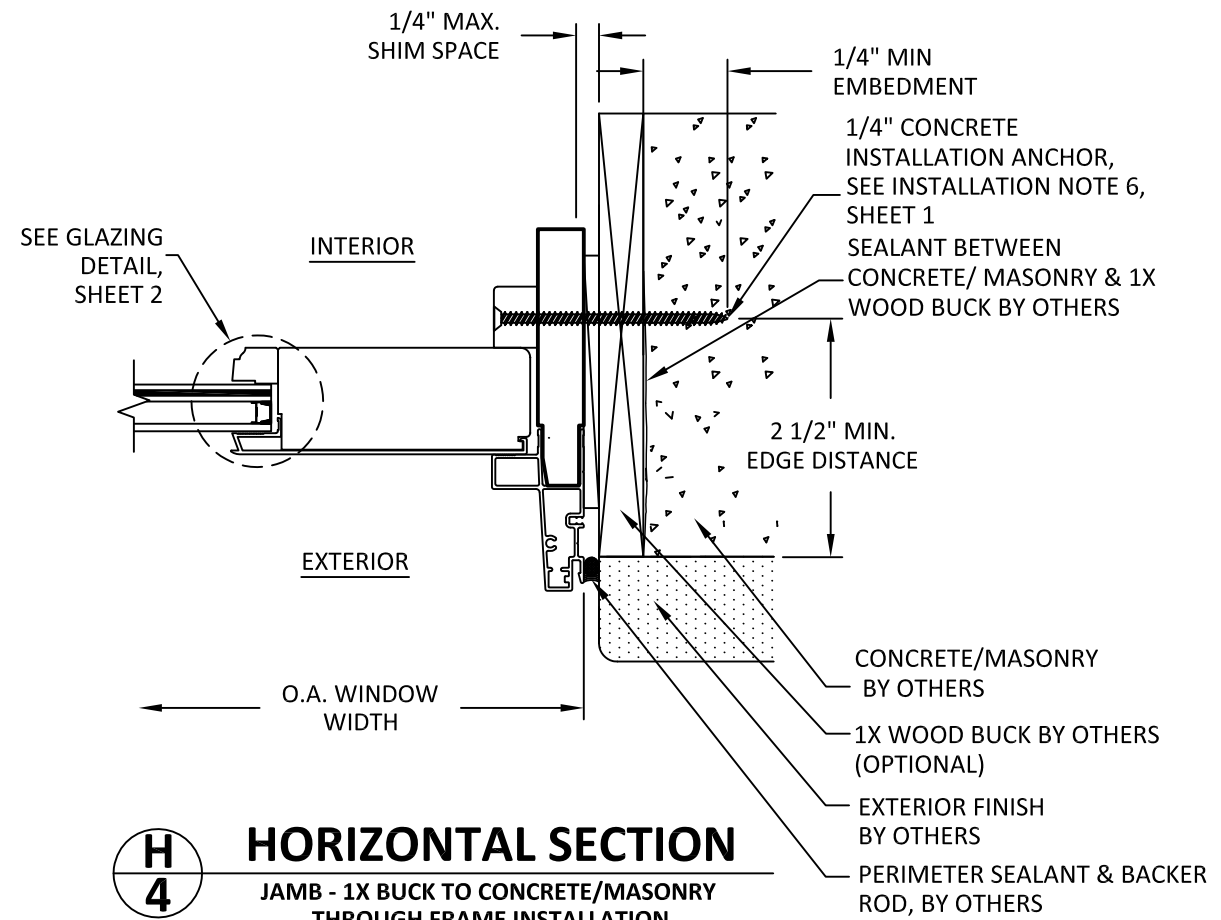

H
4 **HORIZONTAL SECTION**
JAMB - 1X BUCK TO CONCRETE/MASONRY
THROUGH FRAME INSTALLATION

TITLE: PINNACLE CLAD DOOR TRANSOM
IN SASH (IMPACT) (HVHZ)

CLIP INSTALLATION SECTIONS

PREPARED BY:
BUILDING DROPS, INC.

398 E. DANIA BEACH BLVD., STE. 338
DANIA BEACH, FL 33004
PH: (954)399-8478
FAX: (954)744-4738
WEB: www.buildingdrops.com

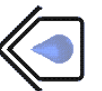

REMARKS	BY	DATE

THE INSTALLATION DETAILS DESCRIBED HEREIN ARE GENERIC
AND MAY NOT REFLECT ACTUAL CONDITIONS FOR A SPECIFIC
SITE. IF SITE CONDITIONS CAUSE INSTALLATION TO DEVIATE
FROM THE REQUIREMENTS DETAILED HEREIN, A LICENSED
ENGINEER OR ARCHITECT SHALL PREPARE SITE SPECIFIC
DOCUMENTS FOR USE WITH THIS DOCUMENT.

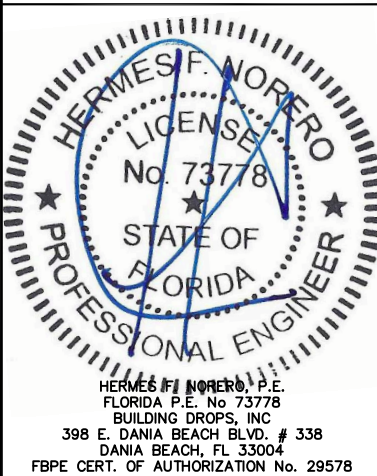

FL #:

FL11482

DATE: 05.03.19

DWG. BY:
SM

CHK. BY:
HFN

SCALE: NTS

DWG. #: WWD045

SHEET:

5

OF 6

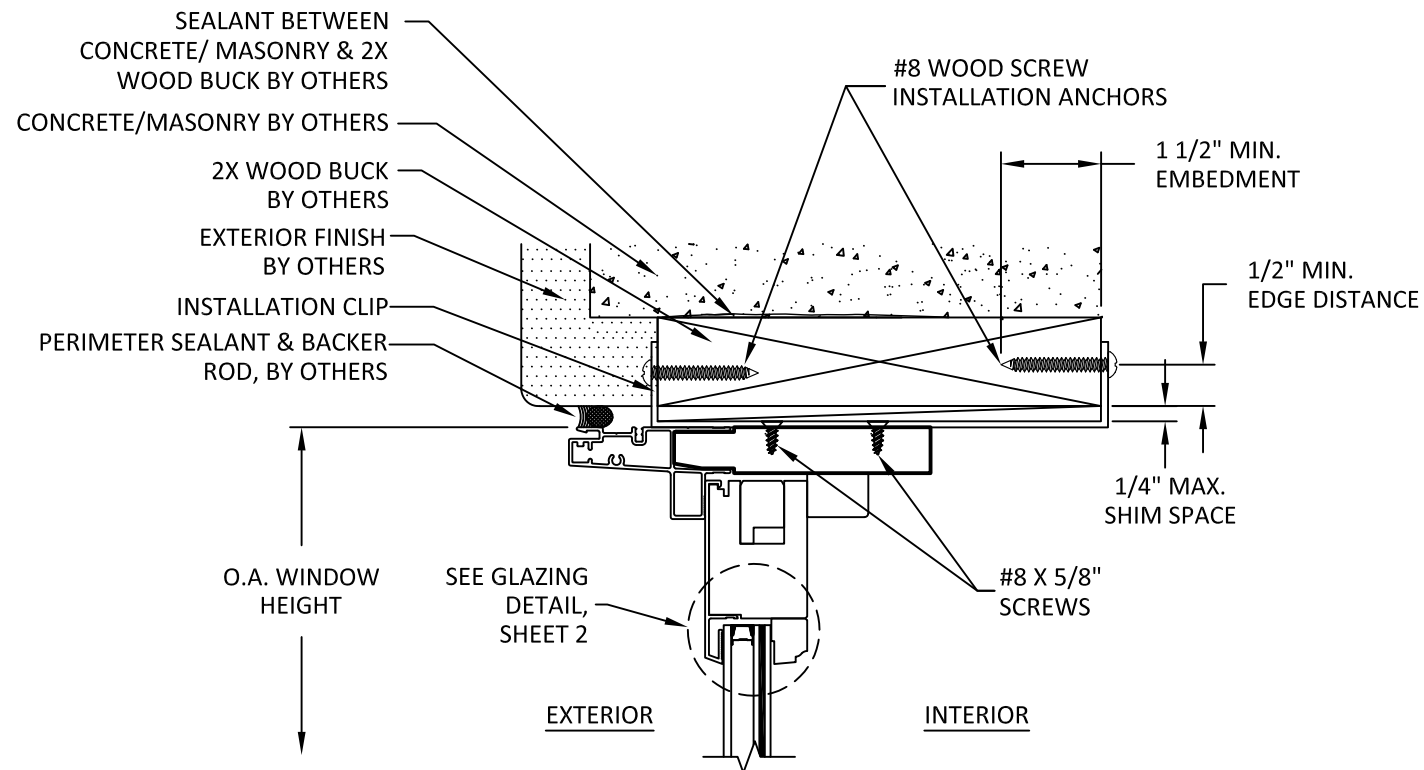

I
5 **VERTICAL SECTION**
HEAD - 2X WOOD BUCK
STANDARD CLIP INSTALLATION

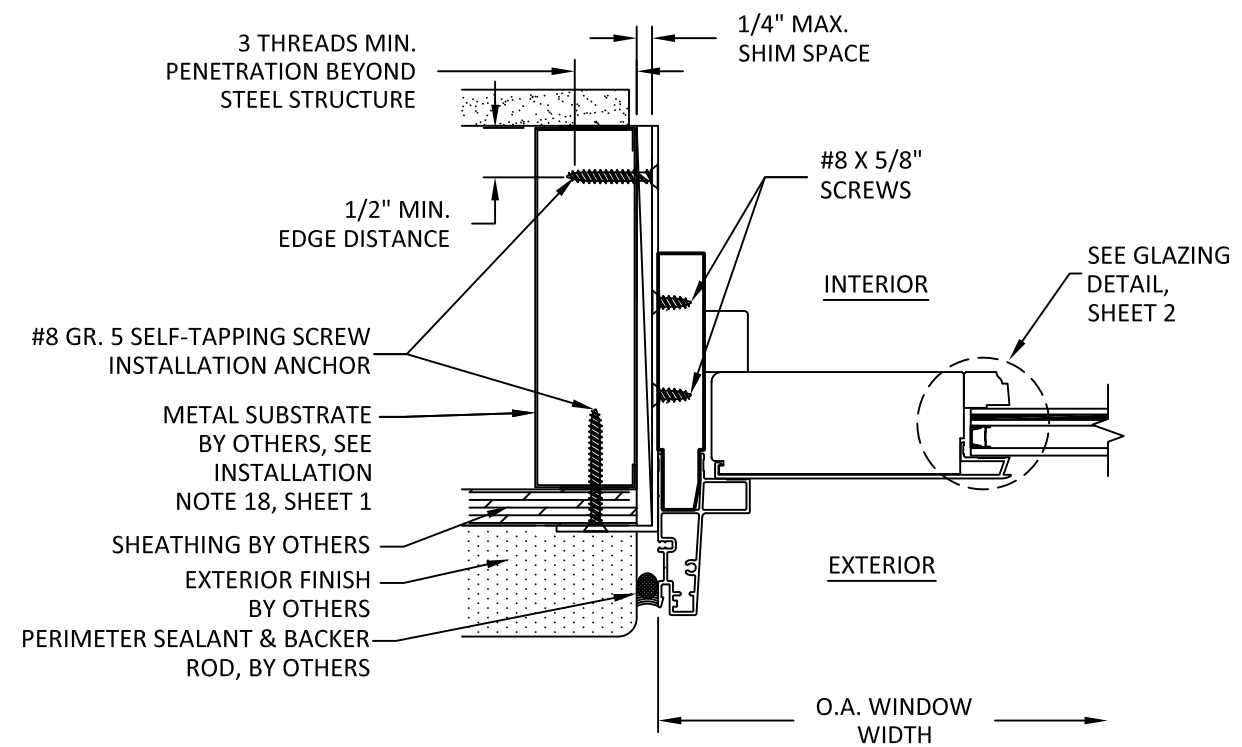

K
5 **HORIZONTAL SECTION**
JAMB - METAL SUBSTRATE
ALTERNATE CLIP INSTALLATION

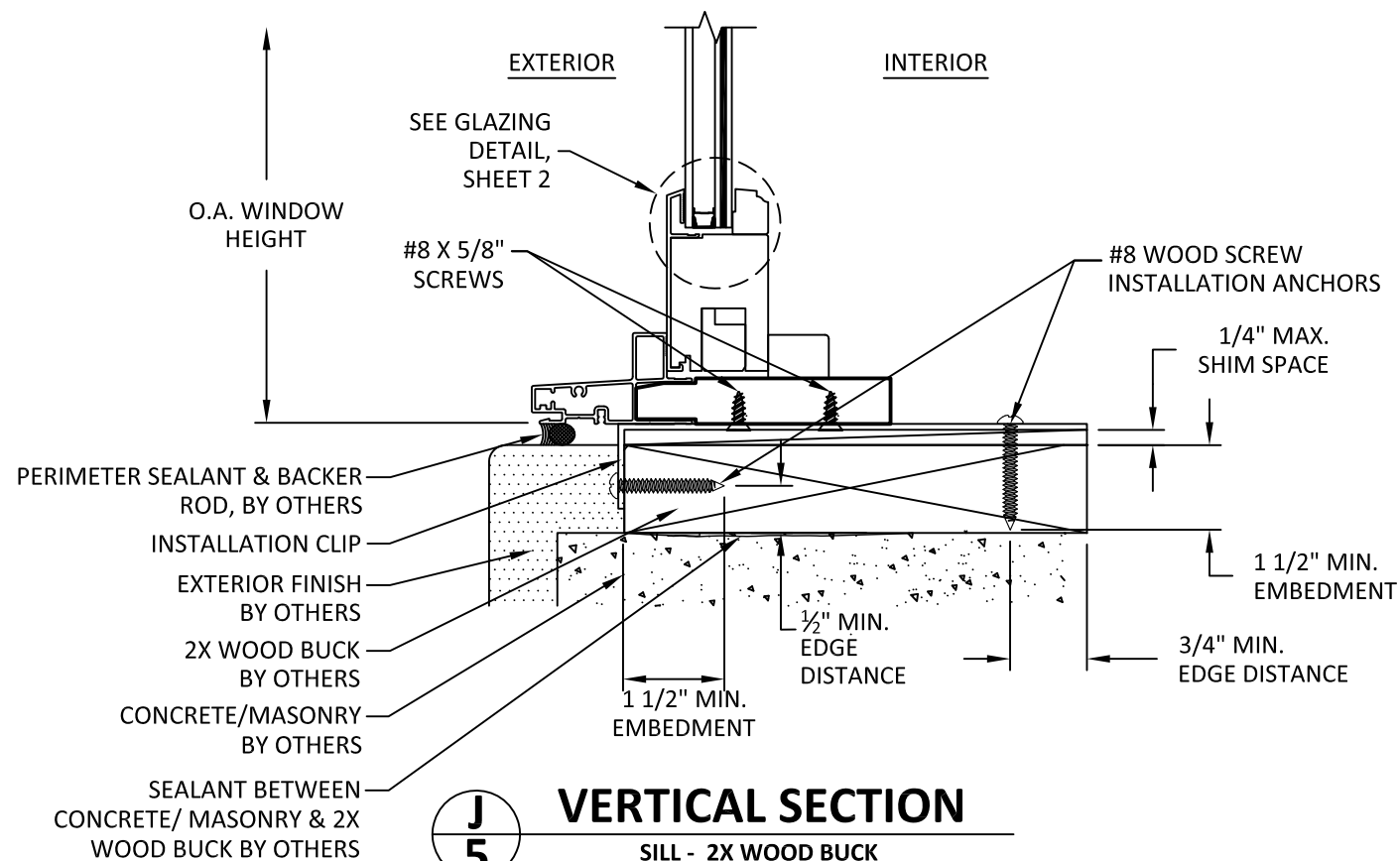

J
5 **VERTICAL SECTION**
SILL - 2X WOOD BUCK
ALTERNATE CLIP INSTALLATION

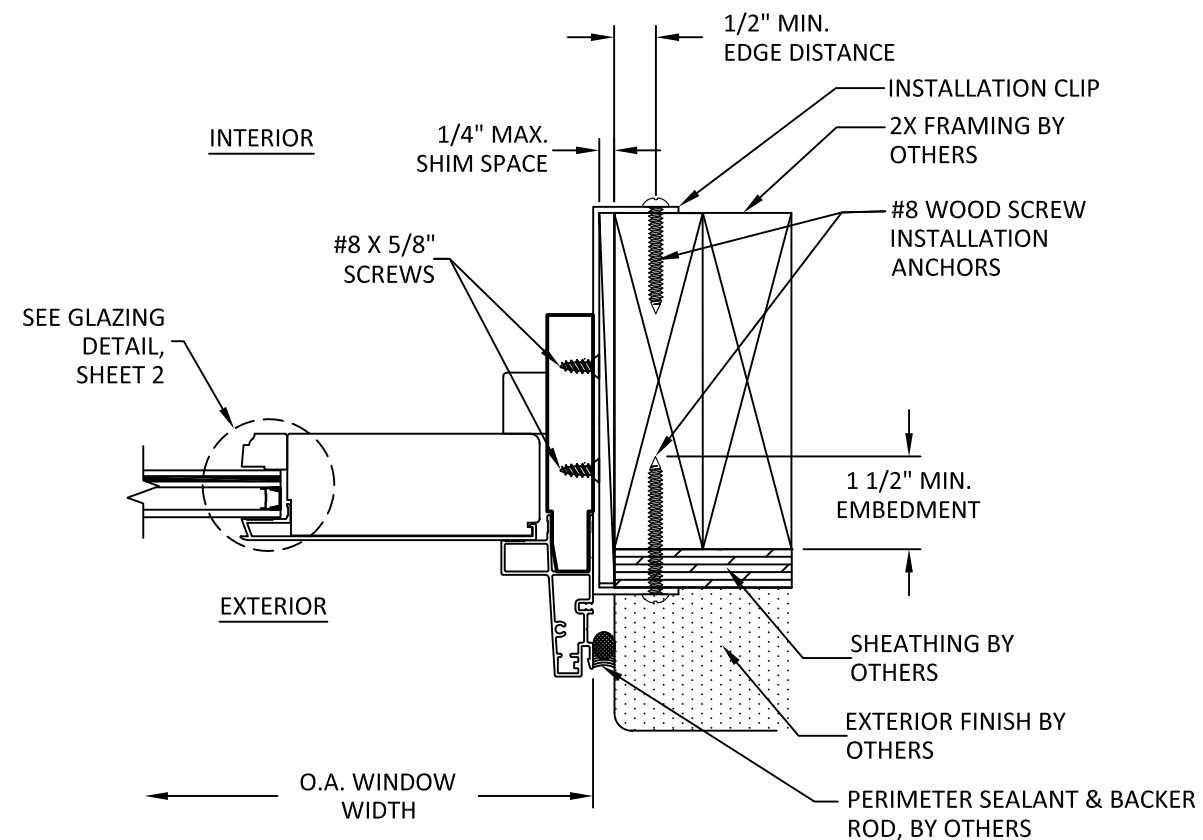

L
5 **HORIZONTAL SECTION**
JAMB - 2X FRAMING
STANDARD CLIP INSTALLATION

s:\projects\windor windows and doors\cc-19-0408 - code change\F11482 in-sash transom window impact-m\dwgs\wwd045.dwg

5/20/2019 11:22 AM

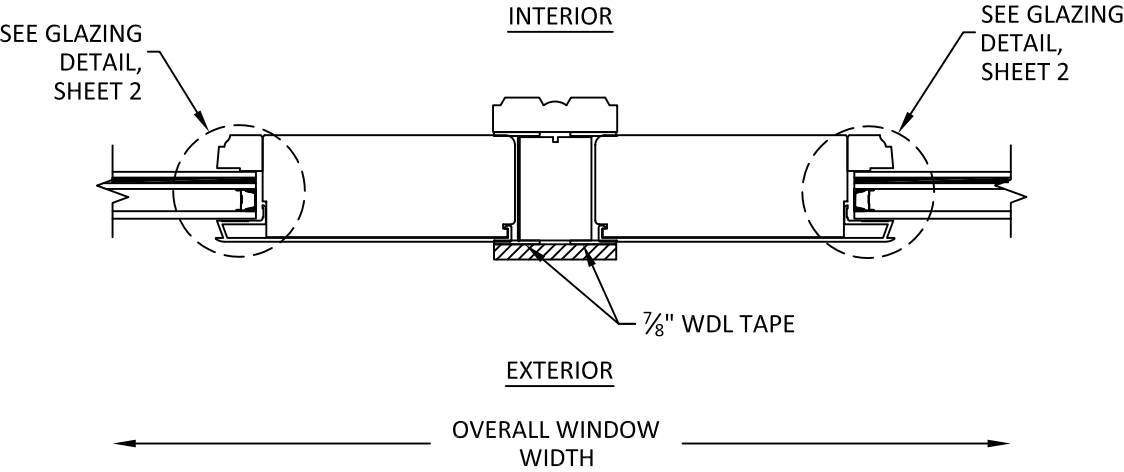

M
6

HORIZONTAL SECTION
VERTICAL MULLION



**WINDSOR WINDOWS
& DOORS**
900 S. 19TH STREET.
WEST DES MOINES, IA 50265
PH: (515)223-6660 FAX: (515)224-1938

TITLE: PINNACLE CLAD DOOR TRANSOM
IN SASH (IMPACT) (HVHZ)

MULLION INSTALLATION
SECTIONS

PREPARED BY: BUILDING DROPS, INC.

398 E. DANIA BEACH BLVD., STE. 338
DANIA BEACH, FL 33004
PH: (954)399-8478
FAX: (954)744-4738
WEB: www.buildingdrops.com



REMARKS	BY	DATE

THE INSTALLATION DETAILS DESCRIBED HERE IN ARE GENERIC AND MAY NOT REFLECT ACTUAL CONDITIONS FOR A SPECIFIC SITE. IF SITE CONDITIONS CAUSE INSTALLATION TO DEVIATE FROM THE REQUIREMENTS DETAILED HEREIN, A LICENSED ENGINEER OR ARCHITECT SHALL PREPARE SITE SPECIFIC DOCUMENTS FOR USE WITH THIS DOCUMENT.



FL #:
FL11482

DATE: **05.03.19**

DWG. BY: **SM** CHK. BY: **HFN**

SCALE: **NTS**

DWG. #: **WWD045**

SHEET:
6

OF 6