

# Installation Guidelines



## FOR PINNACLE SELECT MULTI-SLIDE PATIO DOORS

### Installer

- Read instructions completely before attempting installation. Failure to follow these guidelines will forfeit all warranties (written or implied). Windsor Windows & Doors will not be held responsible for any claims or damages resulting from installation.
- Always provide a copy of these instructions to the homeowner.
- Contact your architect or construction professional for installation into other building designs or construction methods.
- Structural support of the sill is required to support the entire sill width, and depth of the sill's interior edge, to the exterior nose of the sill extrusion. If the architect's details do not include this type of structural support, a structural support must be installed and flashed.
- Regional codes and environmental conditions may require installation that is different from these guidelines. It is your responsibility to ensure that local codes and ordinances are followed.

### Warning

- ⚠ **Work Safe!** Always wear proper eye and hearing protection when installing or adjusting Windsor products. **Use Power Tools**
- ⚠ **Properly!** To avoid personal injury, always follow manufacturers' instructions for safe operation of power tools.
- ⚠ **Ladder Safety!** Working at elevated levels can be hazardous. Always use ladders and scaffolding properly. Consult manufacturers' guidelines for safe use of these types of equipment.

### Important

- Windsor reserves the right to change the information contained in these guidelines without notice.
- Maintain a minimum of 1/4" between the door frame and any trim, siding or masonry.
- Use of Windsor products in barrier EIFS systems (synthetic stucco) is not recommended. To do so will forfeit all warranties (written or implied). Windsor Windows & Doors will not be held responsible for any claims or damages resulting from water infiltration.
- Steel fasteners will corrode when used with ACQ pressure treated lumber. Use corrosion resistant fasteners (such as stainless steel) when installing doors in or around these types of materials.
- Doors must be properly flashed and sealed around the perimeter.

### Handling and Storage

- Always carry door panels upright. Do not carry flat! Doing so could result in damage to the panels.
- Do not store units outside.

**ATTENTION! ARBITRATION AGREEMENT; JURY TRIAL WAIVER; CLASS ACTION WAIVER.** By purchasing, installing, or using this product, you agree to arbitrate any dispute you may have with Windsor relating to your Windsor products, and to waive your rights to a jury trial and to participate in class-action or class-arbitration proceedings, relating to any such disputes. For more details, and to learn how **YOU CAN OPT OUT OF THIS ARBITRATION AGREEMENT AND THESE WAIVERS**, please go to [www.windsorwindows.com/support/Dispute Resolution](http://www.windsorwindows.com/support/Dispute%20Resolution).

## Lead Paint and Existing Window or Door Disposal:

Before any remodel or renovation, make sure to identify any potential lead paint issues and take necessary steps to reduce the risk of lead contamination.

The U.S. Environmental Protection Agency (EPA) has issued a “Lead Renovation, Repair and Painting Rule (RRP)” for remodelers of older homes and buildings. This rule requires training and certification in lead-safe work practices for firms performing renovation, repair or painting on homes and child-occupied facilities built prior to 1978.

For more information regarding procedures for dealing with lead paint, please visit EPA’s website at [www.epa.gov/lead](http://www.epa.gov/lead).

When removing existing windows or doors, make sure to wear appropriate personal protective equipment. Extra precautions should be taken to protect others and property within the vicinity and below the removal window and surrounding components.

Consult with local waste authorities on the proper recycling or disposal of old window or door components.

## Overview of Pinnacle Select Multi-Slide Doors

These sliding doors (also known as telescoping doors) are designed to be an economy system with superior weather performance for a wide array of projects that require a large opening multi-slider. These doors have multiple thermal design features, including specially designed gaskets and iso-bar technology, and are engineered to withstand any climate. Multi-Slide Door Systems are able to open an entryway as much as 100% when pocketing (storing) the doors. Fully customizable, our Multi-Slide Door Systems are state-of-the-art, high-quality, and easy-to-use.

The system is composed of several panels that slide and stack to one or both sides of an opening or are concealed entirely within a pocket.

### RECOMMENDED TOOLS (NOT SUPPLIED):

- Carpenter’s Level (Optional: Laser Level)
- Wrench or Ratchet
- Rubber Mallet
- Tape Measures
- Caulking Gun and Sealant
- Self-Leveling Epoxy
- Power Drill

### INCLUDED PARTS:

- Installation screws
- T-Handle (to tighten key corners)
- Channel Covers
- Key Corners (attached to header)
- Anchors (only for recessed tracks)
- Stopper (only for pocketing units)

## Part 1: Preparing the Opening

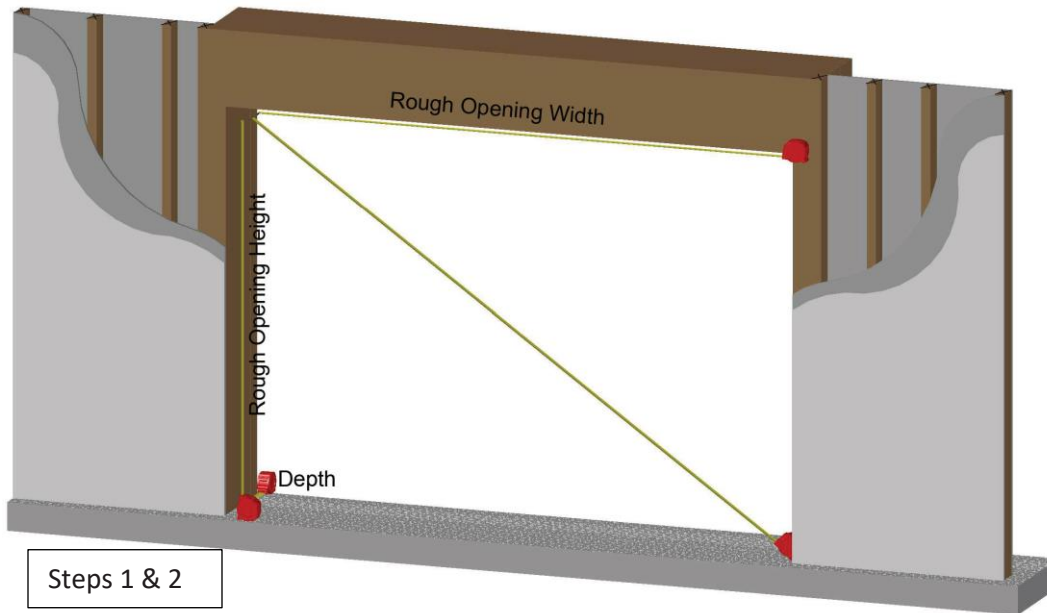

1. Prior to checking the dimensions for the systems, ensure that the opening is square and plumb at size stated in the shop drawings.
2. Using a tape measure, check the height, width, and the dimension across the opening.
3. Placing the Header track and side frames into the opening, check to see that you have at least 1/2" shim space on both ends. ***Shimming & leveling the system properly is highly important, do not over or under shim.***

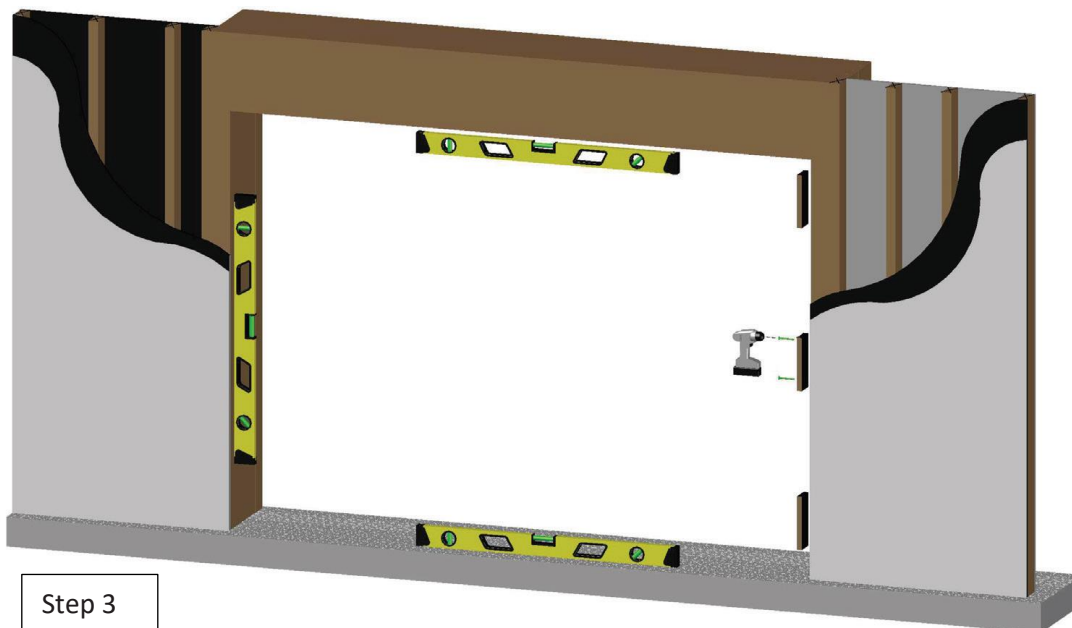

Once you are sure that the header and side frames fit properly, it is time to prepare the opening for the new system. If the opening needs to be shimmed, go ahead and apply the shims as necessary. There should still be at least 1/2" of clearance around the entire system. Check the entire opening to ensure that the opening is level and square. This is one of the most important steps and should not be skipped, to ensure proper operation of the new system.

## Part 2: Preparing the Bottom Track for Installation

The anchorage and leveling of the bottom track are highly important to ensure proper operation and life span of the Sliding System(s) since they are weight driven and bottom loaded.

Please keep in mind that pilot holes are already pre-drilled in the headers, side frames, and bottom tracks. It is highly important that the rough opening and substrate that the system track will be installed to are level, clean, and free of debris (4" Installation screws will be provided with this system; other anchorage bolts will be at the customer's expense).

## Part 3: Bottom Track Installation

The bottom track is cut to the exact size of the overall system width. Windsor Windows & Doors does not recommend any modifications to be done to this system.

**FOR SURFACE MOUNTED TRACK:** Install bottom track on finish floor. Secure track using the screws provided and epoxy seal all screws.

**FOR RECESSED MOUNTED TRACK:** Install bottom track in trench and make sure wheel guide is exposed 3/16" after finish floor is installed.

**FOR ALL 2 1/2" RECESSED TRACK TYPES USING THE LEVELING ANCHORS PROVIDED IN THE KIT:**

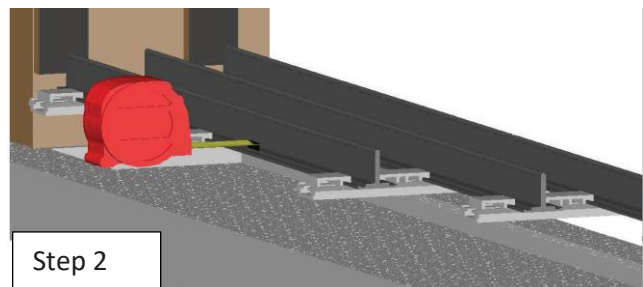
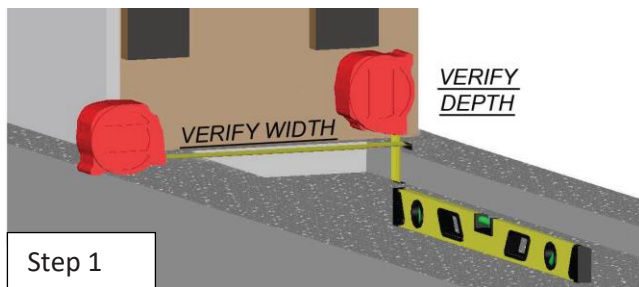

1. Double check the trench depth and width with the actual bottom track provided. The trench depth should have an extra 1/2" shim space provided below the track system setup. *\*Depth varies due to different track types.*
2. Insert Track into floor depression to assure the sizing is correct. Make sure the track is the same size all the way from end to end from edge of slab.
3. Check the track height to assure that a 3/16" lip can be achieved.

## Part 4: Anchor Adjustments (For Recessed Tracks)

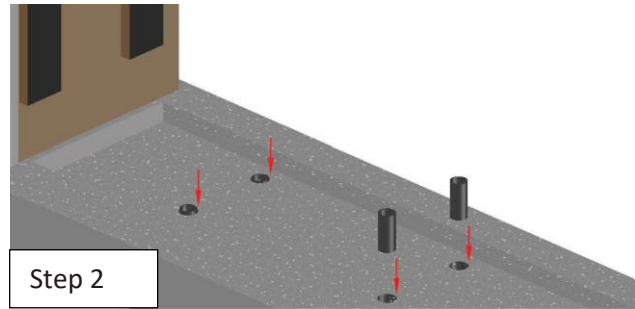
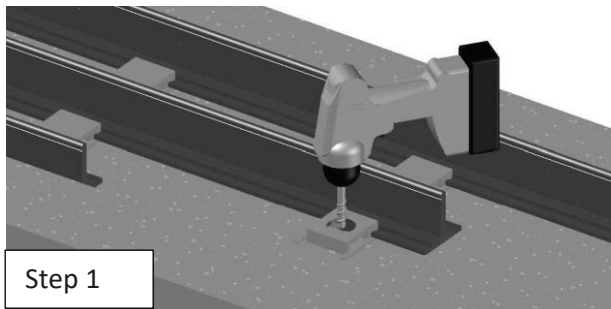

1. Use the track and the provided pilot holes in the “u-channel” as a guide to drill the holes for anchor bolts into the concrete trench. Holes must be 3/8” diameter and 1” deep.
2. Remove the track and drop the anchor receivers into the holes (1/4” x 20 drop-in anchors).
3. **Note:** *Once inserted, lock the anchors into the concrete by hammering internal cone inside the base of the anchor (use settling tool provided with the anchors).*

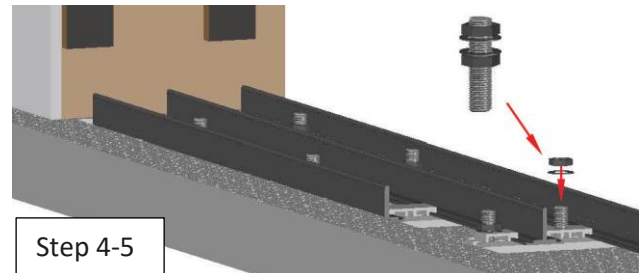
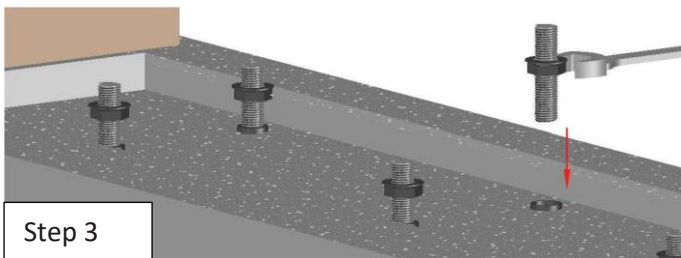

4. Insert the precut 1/4” threaded rod into the installed anchor receivers and then insert the nut and flat washer respectively. Adjust height to achieve 3/16” lip from finish floor.
5. Place washer followed by the nut on top of the “u-channel”.
6. Adjust and tighten the nuts to anchor the track into place. Assure that the system is level as the track is being tightened down.

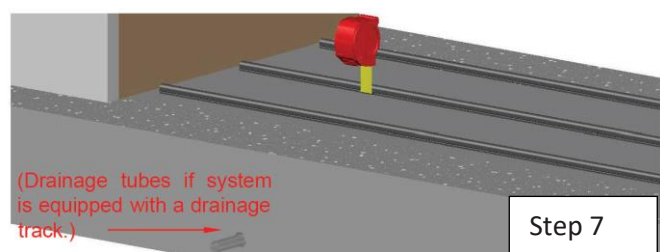
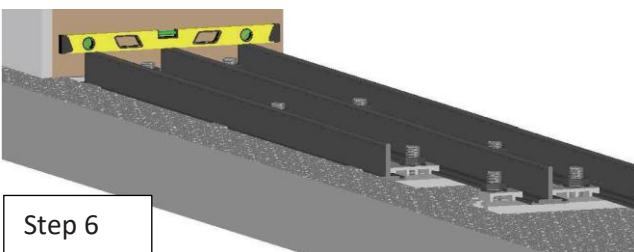

7. Once track is placed, leveled, and the anchor bolts have been secured into the proper place and height, use a level (laser level recommended) to assure the track is completely leveled.
8. When the track is at the correct height and the system has been completely tested with panels, fill all gaps between the tracks to the desired finish. Make sure 3/16” lips are exposed for systems wheels to glide smoothly along the system tracks.

**Note:** *Recessed track installation will vary depending on the type of track purchased. Most recessed tracks will require shims to level the track. After leveling the track in the trench, back fill with high strength cement based grout to ensure adequate support. Recessed tracks utilizing the “u-channel support” will be installed using the anchors provided. These anchors allow the track to be adjusted without the use of any shims. Back fill with concrete after leveling to ensure adequate support.*

## Part 5: Frame Installation

Windsor Windows & Doors is not responsible for the support structure which the system will be attached to. Please ensure that the General Contractor waterproofs the area prior to installation.

1. Loosen the key corners on the header using Allen Key provided with the installation key prior to insertion of the side frame.
2. Insert key corners into the side frame.
3. Make sure both miter cuts (45°) are close together and lock the key corner using a 5mm Allen key.
4. Once built, tilt and turn the frame into the opening.
5. Make sure each track guide is in the center of each side frame channel. Adjustable keeper should be aligned with lead panel bottom track guide.

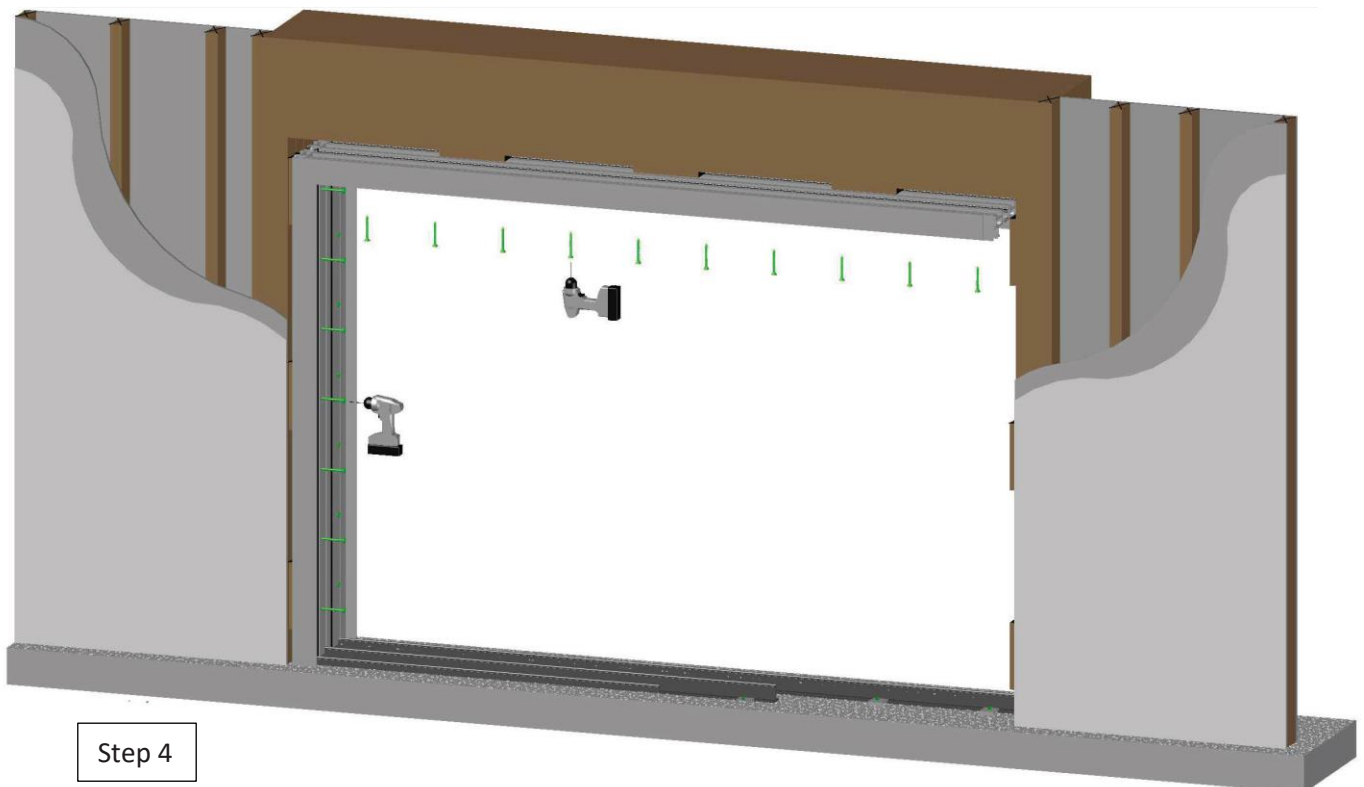
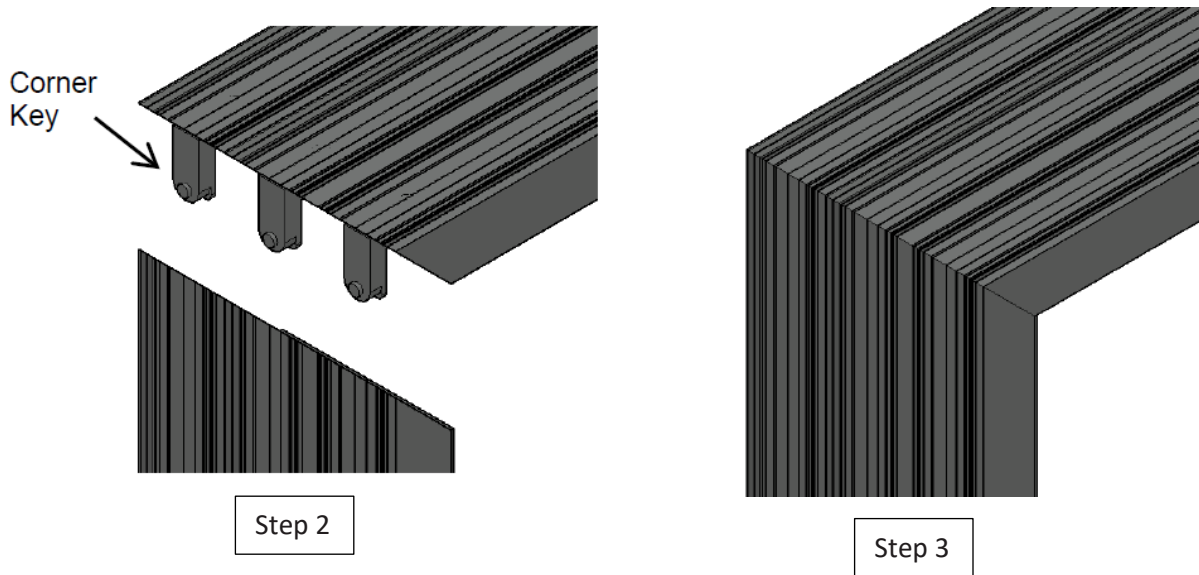

## Part 6A: Panel Installation with No Pockets

Every system comes from the factory already tested to ensure proper operation of each panel and wheel mechanism.

1. Insert the fixed panel first and screw side jamb into place.
2. Insert and angle the top of the second panel into the frame channel. Make sure that the interlocks overlap (continue installing the remaining panels starting from the fixed to the lead panel in that order.)
3. Insert the lead panel and engage the handle by locking it.
4. Once the frame is installed, using silicon to seal all joints and gaps around the frame.

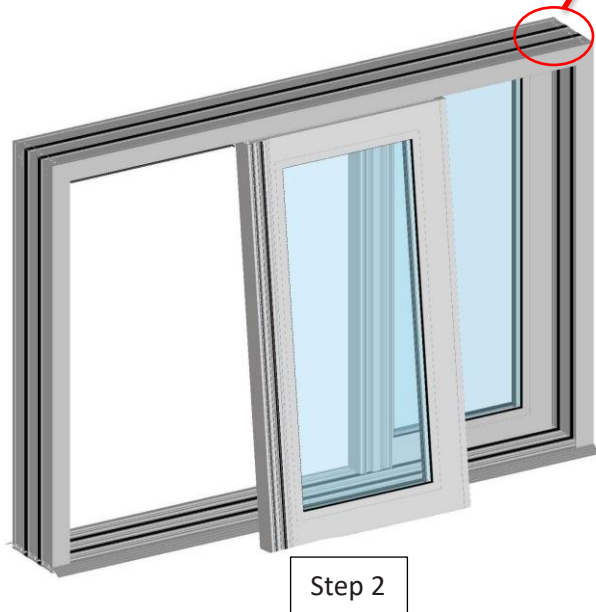
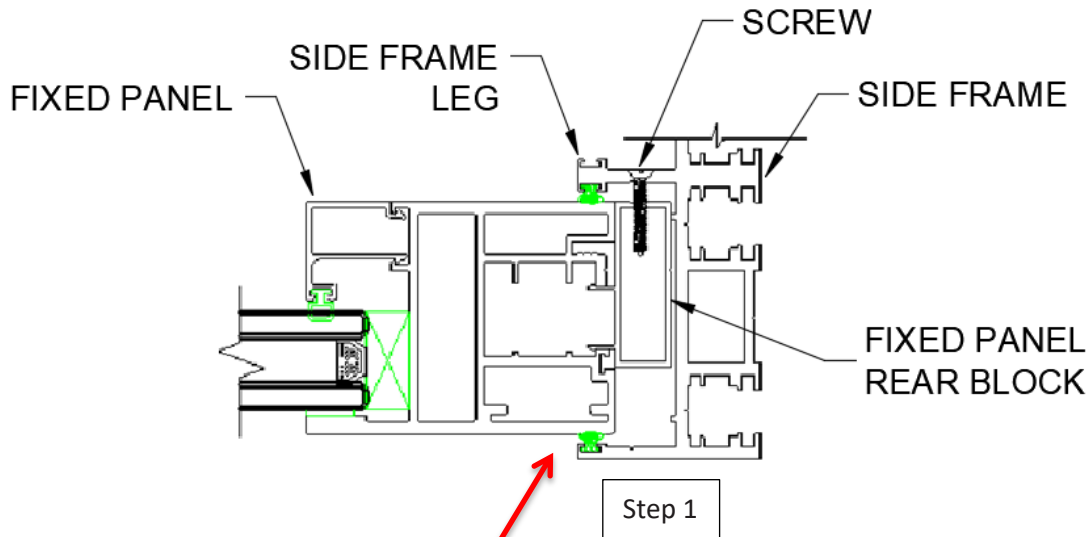



## Part 6B: Panel Installation with Pockets

Every system comes from the factory already tested to ensure proper operation of each panel and wheel mechanism. When installing the panel, make sure that the panels are inserted to where the panel interlocks will be on the proper sides of each other. If the panels are inserted to the where the interlocks are on the incorrect sides of the panels, the door will not operate correctly and it may cause damage to the system.

1. Insert the first pocket panel. This panel will have the pocket board combo piece already attached. Follow typical panel installation.
2. Insert second panel angled top first at and make sure that the interlocks overlap (See diagrams on pg. 7). Continue installing the remaining panels starting from the pocket panel to the lead panel in that order.
3. Insert the lead panel and engage the handle by locking it.
4. Ensure that the roller mechanism is level and equal on the track.
5. Once are the panels are installed correctly, proceed to installing the exterior side interlock clip. This piece will anchor straight to the wall and can be covered with a finish per adjacent wall.
6. Finally, attach the pocket board to the rest of the system by placing the pocket board against the 2x4 triangle anchorage pieces and use the provided #4 screws to attach. The brushed gasket side goes to the interior wall side. This completes the pocket system install.

If there is a bi-parting pocketing system there will be no side frames. Instead there will be 2 pocket board interlock setups for each side of the system. Follow the steps as if one pocket is installed.

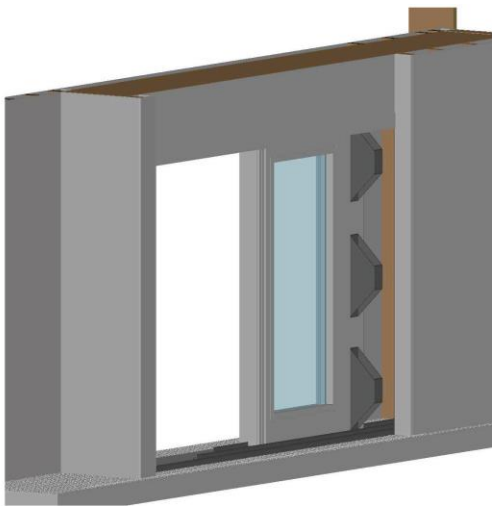

Step 1

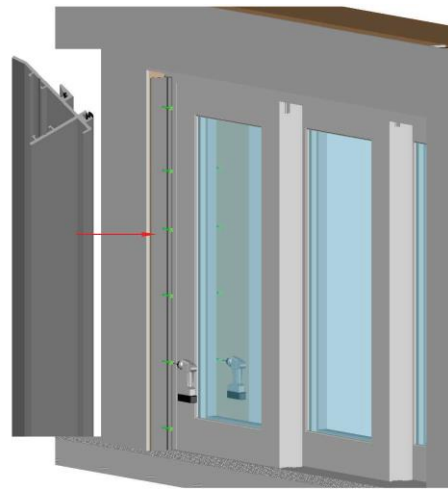

Step 5

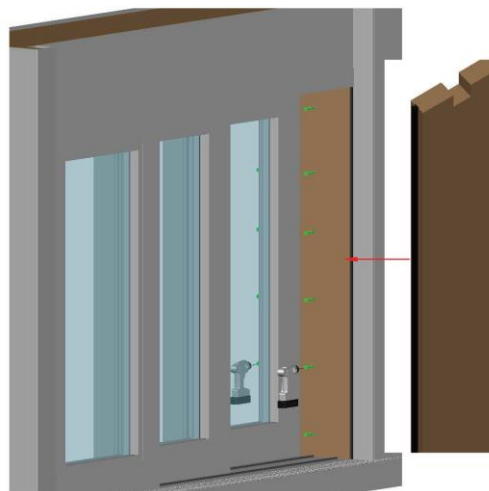

Step 6



## Part 7: Completion and Adjustment

1. Panel Adjustment:
  - a. The lower corners of each operable panel can be adjusted up or down by removing the adjustment screw covers and using a Philips screwdriver to adjust up (clockwise) or down (counterclockwise).
  - b. Adjust rollers independently until the sides of the panels are parallel with the side jamb and adjacent panels.
  - c. Adjust both rollers up or down if needed to improve operation.
2. Keeper Adjustment:
  - a. Adjust lock keepers until door locks easily
  - b. Lock keepers can be adjusted up/down and side-to-side
3. Operate door unit to ensure proper operation. The panel will not operate correctly if the door is out of square, over-shimmed or over-insulated.
4. Completely seal around exterior perimeter between door frame and rough opening or wall exterior.
5. Remove all labels or shipping materials.
6. Properly finish all wood/cellular PVC interior and exterior components within 60 days of installation. See the Care and Use Guide located at [www.windsorwindows.com](http://www.windsorwindows.com) for further details on finishing Pinnacle multi-slide doors.
7. **IMPORTANT:** Do not stain or paint any hardware or vinyl components.
8. Apply the handle set as appropriate per manufacturers' recommendations. Complete final adjustments as necessary.
9. Sliding doors are to remain closed and locked during construction to prevent site conditions from damaging and/or warping panels and frames. Allow 10-12 weeks from project completion for building temperature and humidity levels to stabilize and door panels to acclimate.

## Part 8: System Finishing

Once all of the steps are completed and the new systems are installed, it is time to properly seal the system. We recommend that all finish work be completed by a General Contractor to fully seal and close the openings.

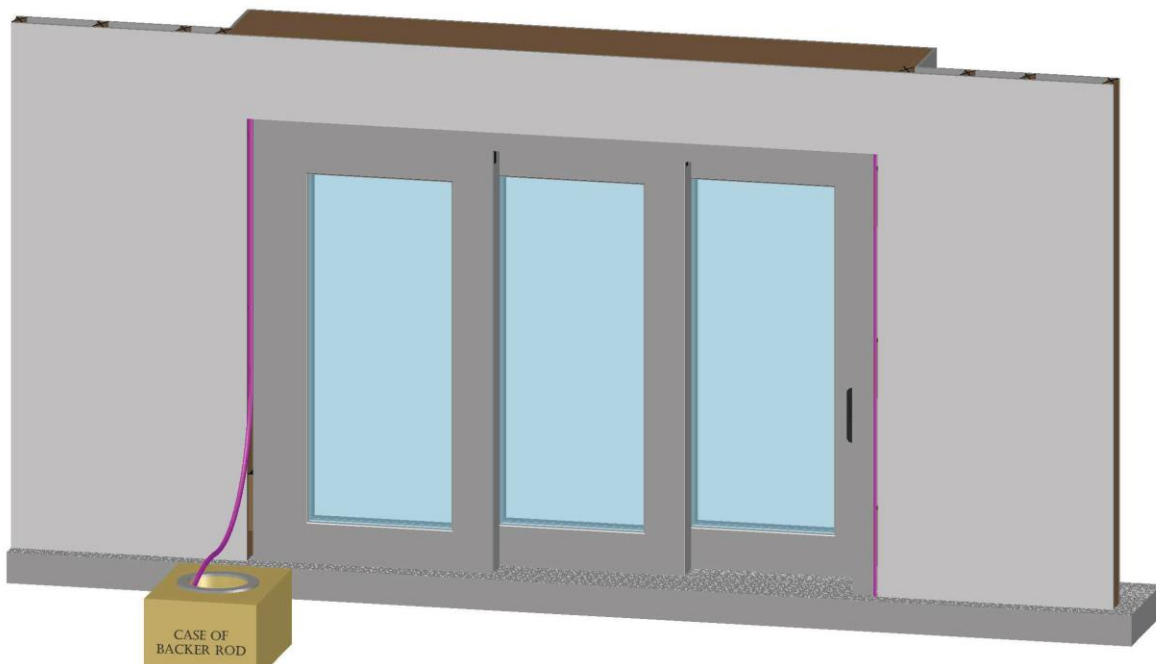

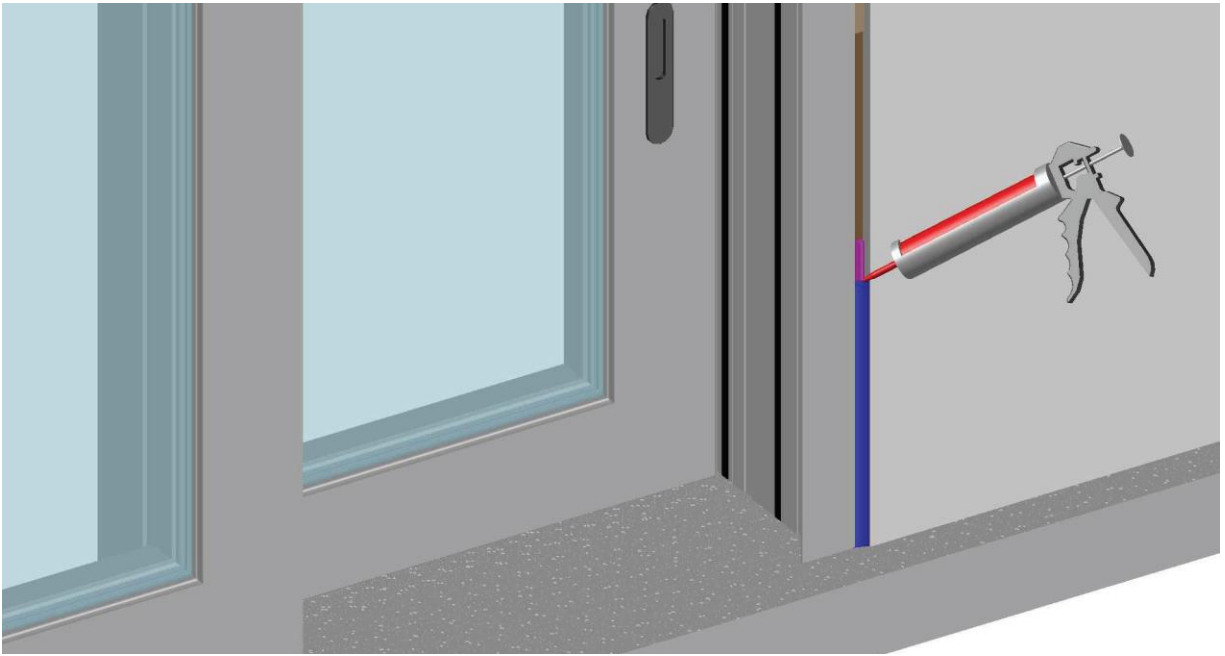

**If you have any questions regarding your Windsor Windows, please contact Windsor Windows & Doors directly at 1-800-218-6186.** Or you can visit us online at [www.windsorwindows.com](http://www.windsorwindows.com), where you will find helpful information as well as our Care and Use Guides, which will to assist you in preserving your windows and patio doors. While you are at our site, you can also complete and submit the form on the Contact page, and one of our window specialists will promptly answer your question.

## Care and Use

For information about the care and use of your Windsor products, please visit the [www.windsorwindows.com/support](http://www.windsorwindows.com/support), and click “Warranty, Care, & Installation,” where you find a link to our Care and Use Guide. Or contact your local independent Windsor distributor and ask for a copy of the Care and Use Guide, which contains information on finishing, cleaning,

what to look for during yearly inspections, general maintenance tips, sash/panel adjustment, sash/panel removal, screen removal and information on condensation. You should inspect your windows or doors annually.

## Warranties

**You can find a copy of our current Warranty at the website, under the “Support” tab.** If you have Windsor products that are older, please contact Windsor at 1-800-218-6186, and we will provide a copy of the applicable warranty.